

The long clamp adjustment knob shaft can protrude too far down when fully tightened onto larger type control shafts and center column arms, creating an obstruction or hazard. Use the short clamp adjustment knob to remove the obstruction.

To replace clamp adjustment knobs:

1. Remove the rubber padding from the lower clamp by carefully peeling it away to reveal the Allen screw. This screw secures the lower clamp to the long clamp adjustment knob.
2. Use the supplied Allen wrench to remove the screw, washer, and lower clamp from the long clamp adjustment knob.
3. Remove the long clamp adjustment knob by turning it counter-clockwise.
4. Install the short clamp adjustment knob by turning it clockwise until it protrudes through the clamp frame.
5. Reassemble the washer and Allen screw onto the short clamp adjustment knob and tighten.
6. Reinstall the rubber padding.

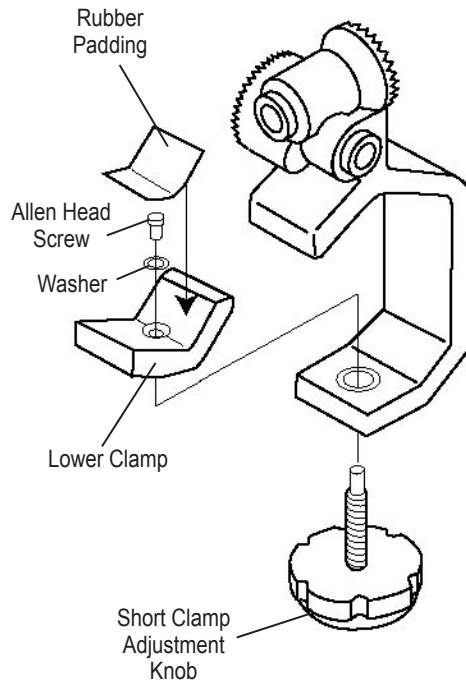

NOTE: Verify the lower clamp is properly oriented in the clamp frame as illustrated.

A cable clamp is provided on the top of the yoke mount to secure the 12-Volt adapter cable provided with the GPSMAP 196/296/396. If you intend to use your GPSMAP 196/296/396 primarily in an aircraft and not in an automobile, you can secure the cable with this clamp. Use of the clamp reduces the risk of loose wires becoming a hazard during operation of the aircraft controls.

© Copyright 2005 Garmin Ltd. or its subsidiaries
 Garmin International, Inc.
 1200 East 151st Street, Olathe, Kansas 66062, U.S.A.
 Garmin (Europe) Ltd.

Unit 5, The Quadrangle, Abbey Park Industrial Estate, Romsey, SO51 9DL, U.K.
 Garmin (Asia) Corporation

No. 68, Jangshu 2nd Road, Shijr, Taipei County, Taiwan
 www.garmin.com

Printed in Taiwan

Part Number 190-00603-00 Rev. B



GPSMAP 196/296/396 YOKE MOUNT

INSTALLATION INSTRUCTIONS

The GPSMAP 196/296/396 Yoke Mount comes fully assembled and includes:

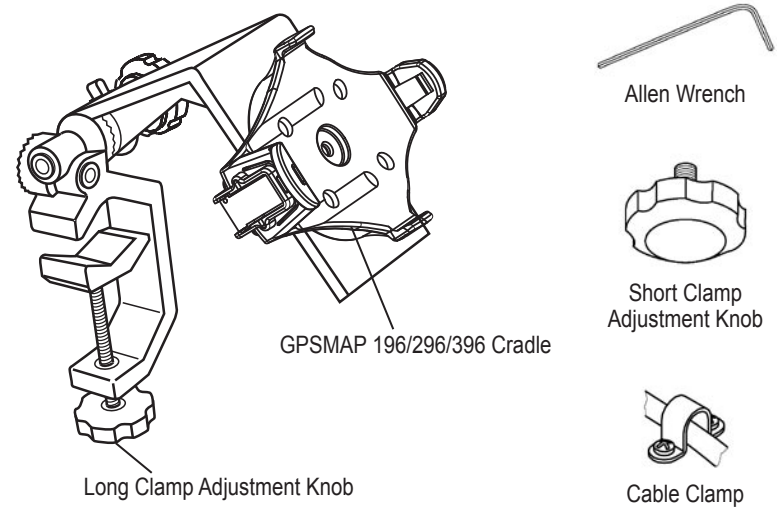

WARNING: It is the sole responsibility of the owner/operator of the GPSMAP 196/296/396 to place this mount and secure the unit so that it will not interfere with the aircraft's operating controls and safety devices, or cause damage or personal injury in the event of an accident or turbulence. Do not mount the GPSMAP 196/296/396 in a place where the pilot or passengers are likely to impact it in an accident, collision, or turbulence. The mounting hardware provided by Garmin is not warranted against turbulence, collision damage, or related consequences.

The yoke mount is packaged pre-assembled and includes a short clamp adjustment knob, a cable clamp, and Allen wrench.

Larger yoke control shafts or center column arms require the short clamp adjustment knob for correct configuration. Refer to page 4 for instructions on changing adjustment knobs.

The yoke mount is designed to fit the majority of conventional aircraft yokes and center column controls. When you remove this yoke mount from the package, it is configured for conventional aircraft yokes. If you have center column control, you must remove the clamp assembly from the rest of the yoke mount. Rotate the clamp 90° so that the open end of the clamp faces away from you and reattach it to the rest of the yoke mount. Refer to the illustrations and instructions on page 3.

To attach the yoke mount to the yoke shaft or control arm:

1. Open the clamp by turning the clamp adjustment knob counter-clockwise until it can be easily placed over the yoke shaft or control arm.
2. When in place, tighten the clamp adjustment knob.
3. Use the pivot knob to position the yoke mount.

To install the GPSMAP 196/296/396 in the yoke mount:

1. Make required auxiliary power, mini USB, and remote GPS antenna cable connections on the back of the unit. Clip the GPSMAP 196/296/396 into the cradle of the yoke mount.
2. Slide the locking lever on the side of the cradle forward to secure the GPSMAP 196/296/396 in place.
3. Adjust the cradle for best viewing and operation of the GPSMAP 196/296/396, and then tighten the knob.
4. To remove the GPSMAP 196/296/396, slide back the locking lever on the the cradle, and then unclip the unit from the cradle.

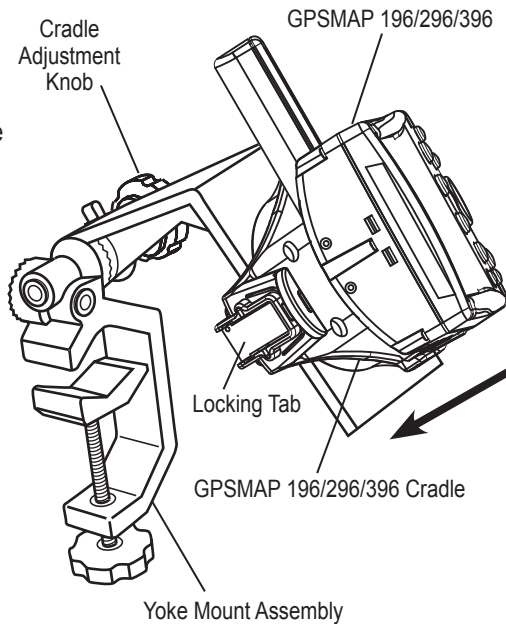

NOTE: You may need to readjust the GPSMAP 196/296/396 position to provide the best view of the display screen as lighting conditions change.

To secure the cable on the top of the yoke mount:

1. Remove the screws securing the cable clamp.
2. Orient the cable and secure with the clamp.

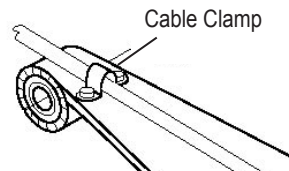

To reconfigure the yoke mount for center column yokes:

1. Loosen and remove the pivot knob spacer and rubber washer.
2. Rotate the clamp assembly 90° so that the clamp opening faces away from you.
3. Secure the clamp assembly to the rest of the yoke mount using the pivot knob, spacer, and rubber washer. Adjust the clamp angle before fully tightening the pivot knob.

Yoke Mount in Conventional Configuration

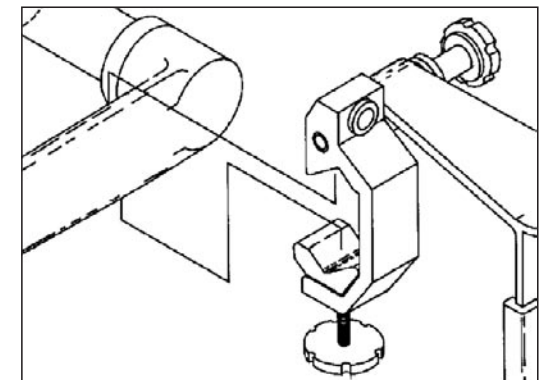
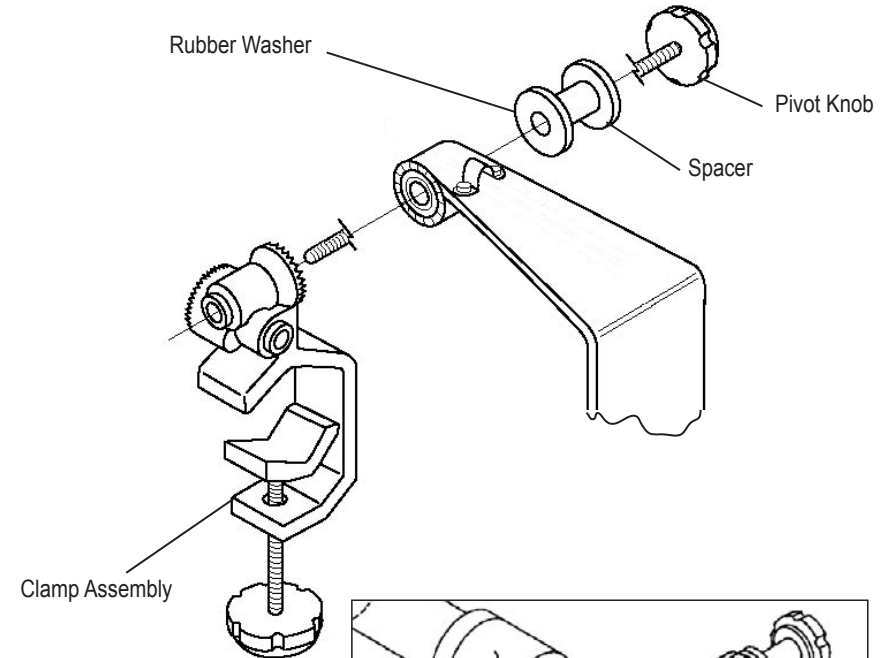

Yoke Mount in Forward-Facing Configuration