

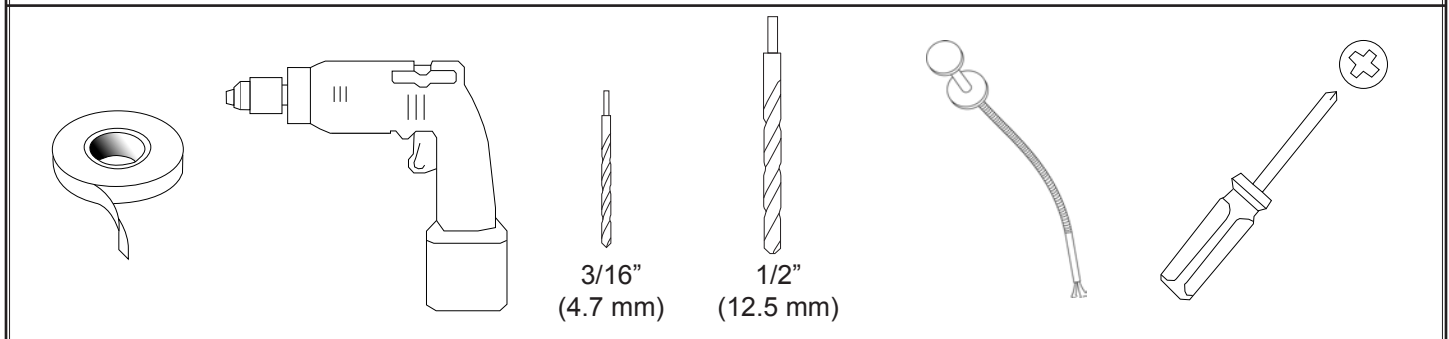

Navus™: Jeep® Compass, Patriot

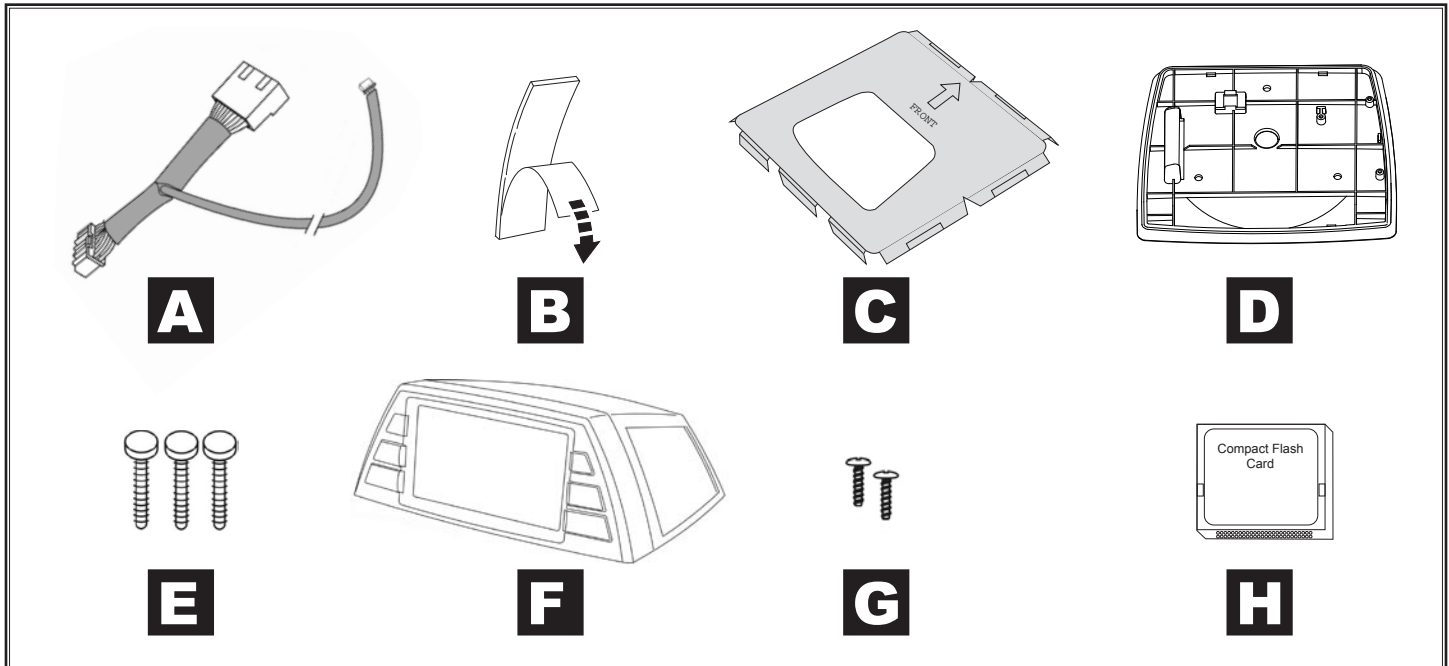

- Disconnect and isolate the negative battery cable.
- Clean dash with isopropyl alcohol.
- Follow the instructions inside to mount the Navus.
- Positioning the template correctly is very important!
- When attaching baseplate to dash, press firmly to activate adhesive.
- Route cable behind separator in dash to avoid pinching cable.
- Apply mercury warning label to B-pillar, as shown.

- Débranchez et isolez le câble négatif de la batterie.
- Nettoyez le tableau de bord avec de l'alcool isopropylique.
- Suivez les directives incluses pour installer le Navus.
- Il est très important de placer le gabarit correctement!
- Pour fixer le socle sur le tableau de bord, appuyez fermement afin d'activer l'adhésif.
- Acheminez le câble derrière le séparateur afin de ne pas pincer le câble.
- Apposez l'étiquette d'avertissement de mercure sur le montant B, comme illustré.

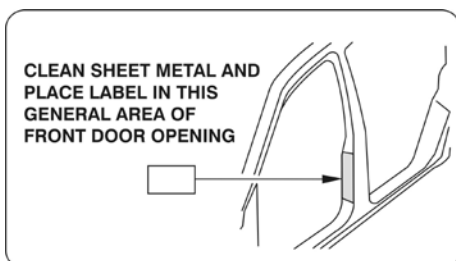

K6859544

1

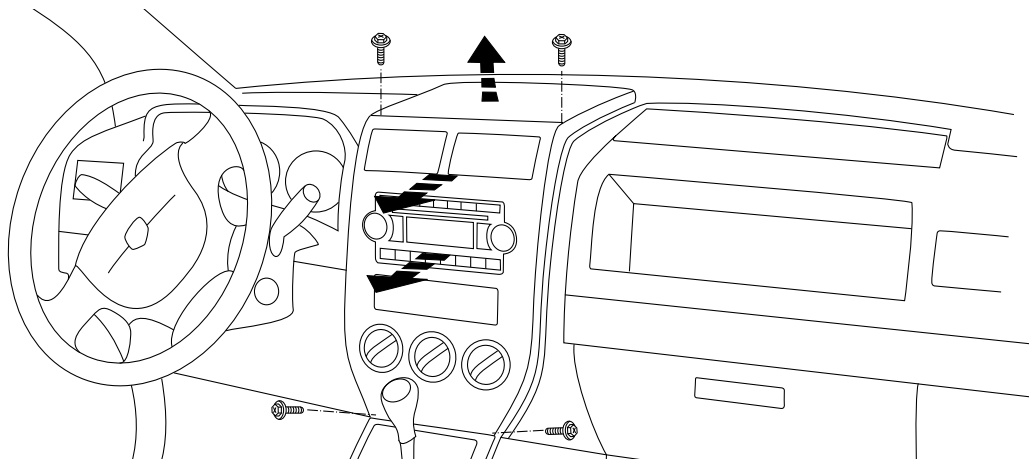

Remove top panel, screws, trim panel, and radio. ♦
Retirez le panneau supérieur, les vis, le panneau de garniture et la radio.

2

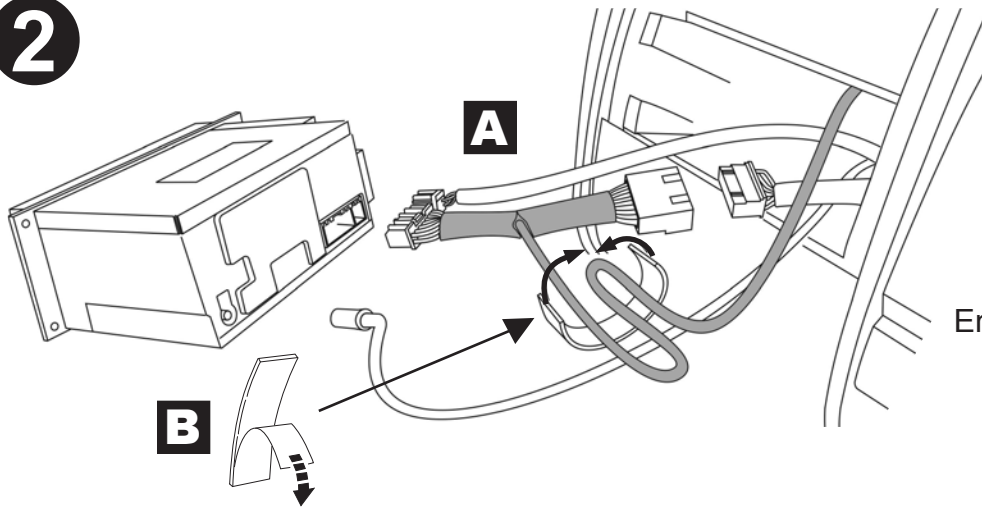

Route cables. ♦
Acheminez les câbles.
Wrap foam tape around
cables. ♦
Enveloppez la bande mousse
autour des câbles.

3

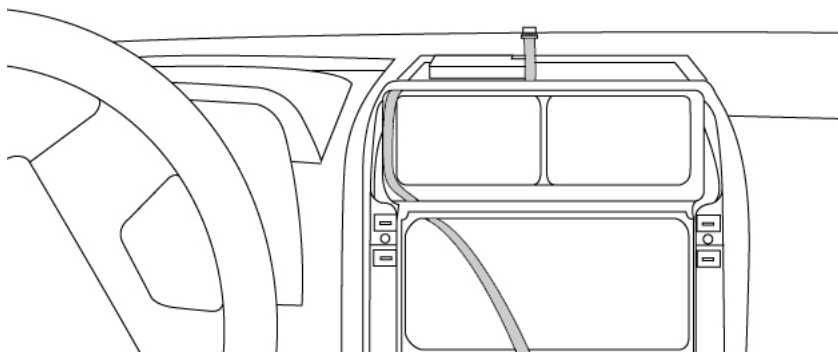

4

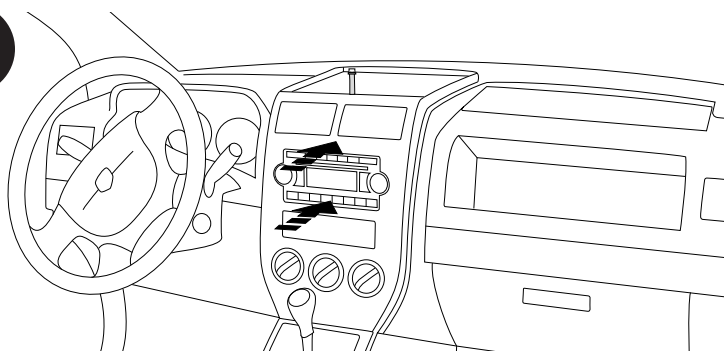

Reinstall radio, trim panel, and screws.
(Do not reinstall top panel.) ♦

Réinstallez la radio, le panneau de
garniture et les vis.
(Ne réinstallez pas le panneau
supérieur.)

5

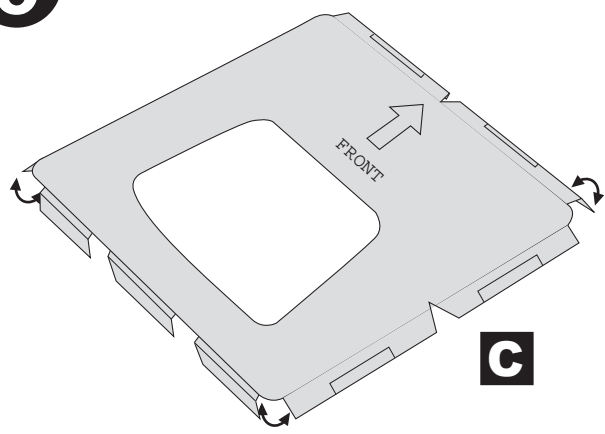

Fold template. ♦ Pliez le gabarit.

6

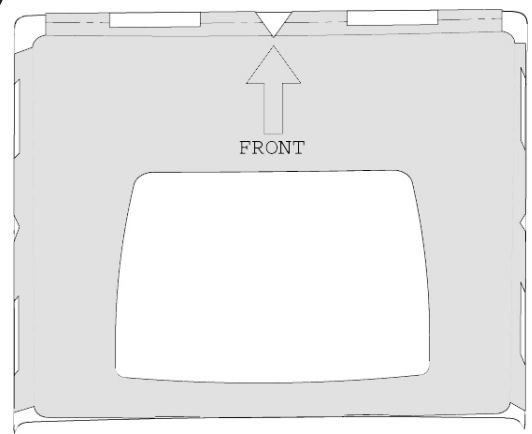

Secure on top panel. ♦ Fixez-le sur le tableau de bord.

7

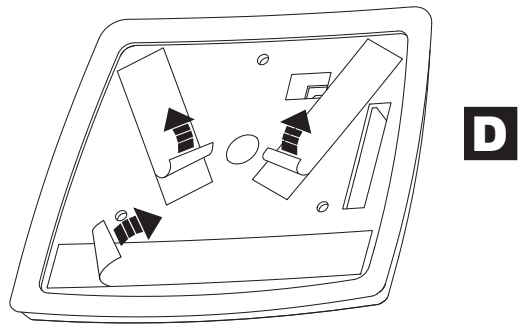

Remove tape liners from baseplate. ♦ Enlevez les bandes protectrices du socle.

8

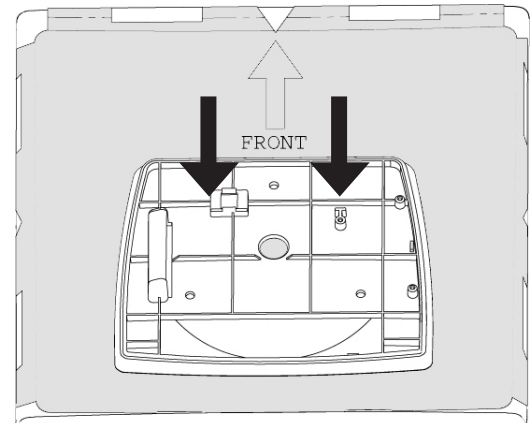

Place on top panel. Press firmly 10 seconds. ♦ Placez-le sur le tableau de bord. Appuyez fermement pendant 10 secondes.

9

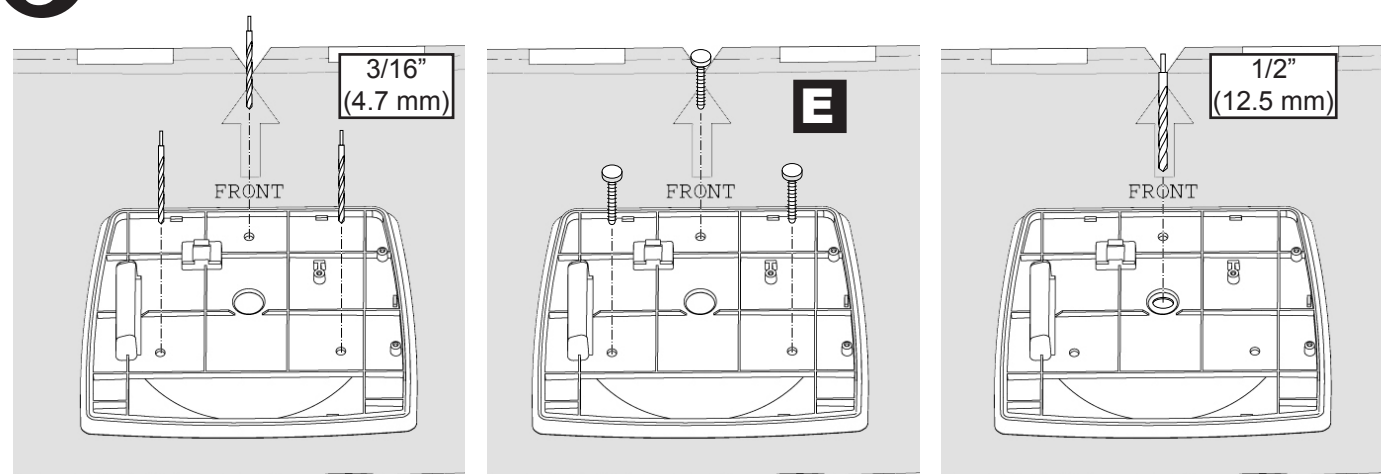

10

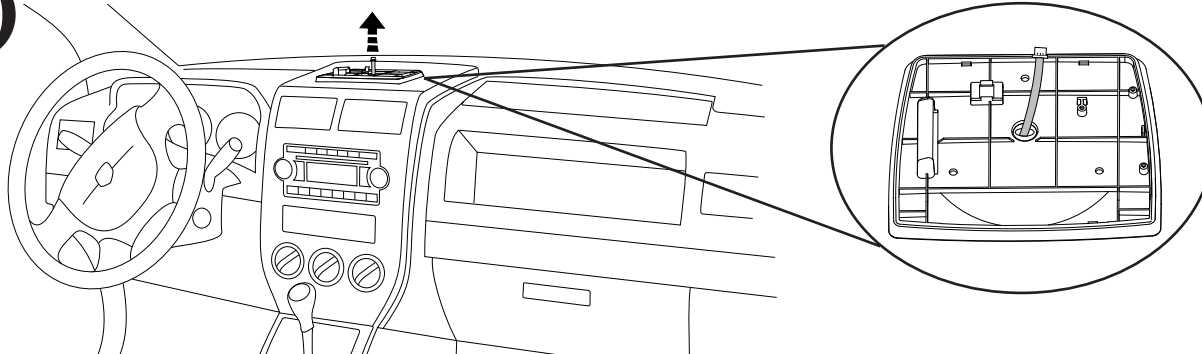

Reinstall top panel. Route cable. ♦ Réinstallez le panneau. Acheminez le câble.

11

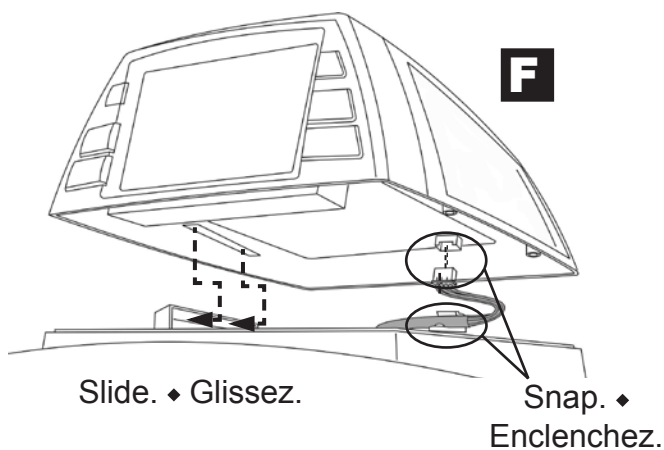

Slide. ♦ Glissez.

Snap. ♦ Enclenchez.

12

Screw down. Insert CF card. ♦ Vissez. Insérez la carte CF.

