

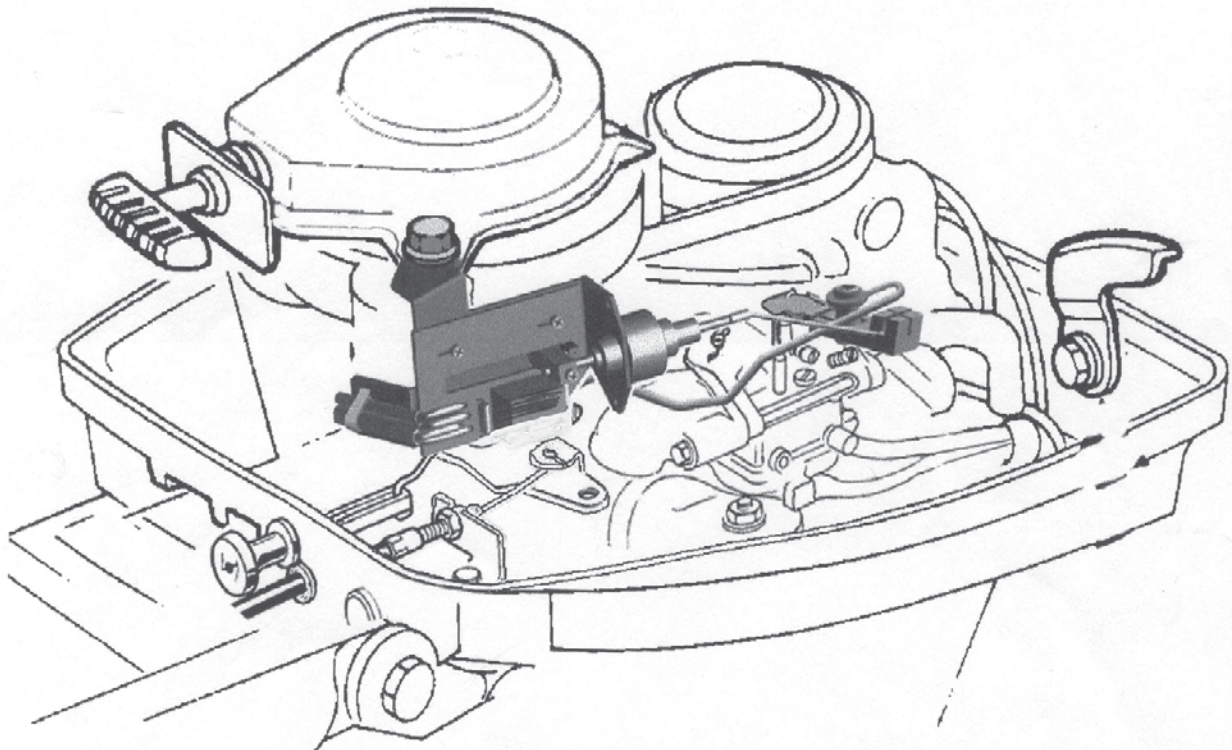

TR-1 Gold

Throttle Actuator Installation Instructions

Honda 8 HP 1987-2000



Parts: Kit Number: 120-0052-01

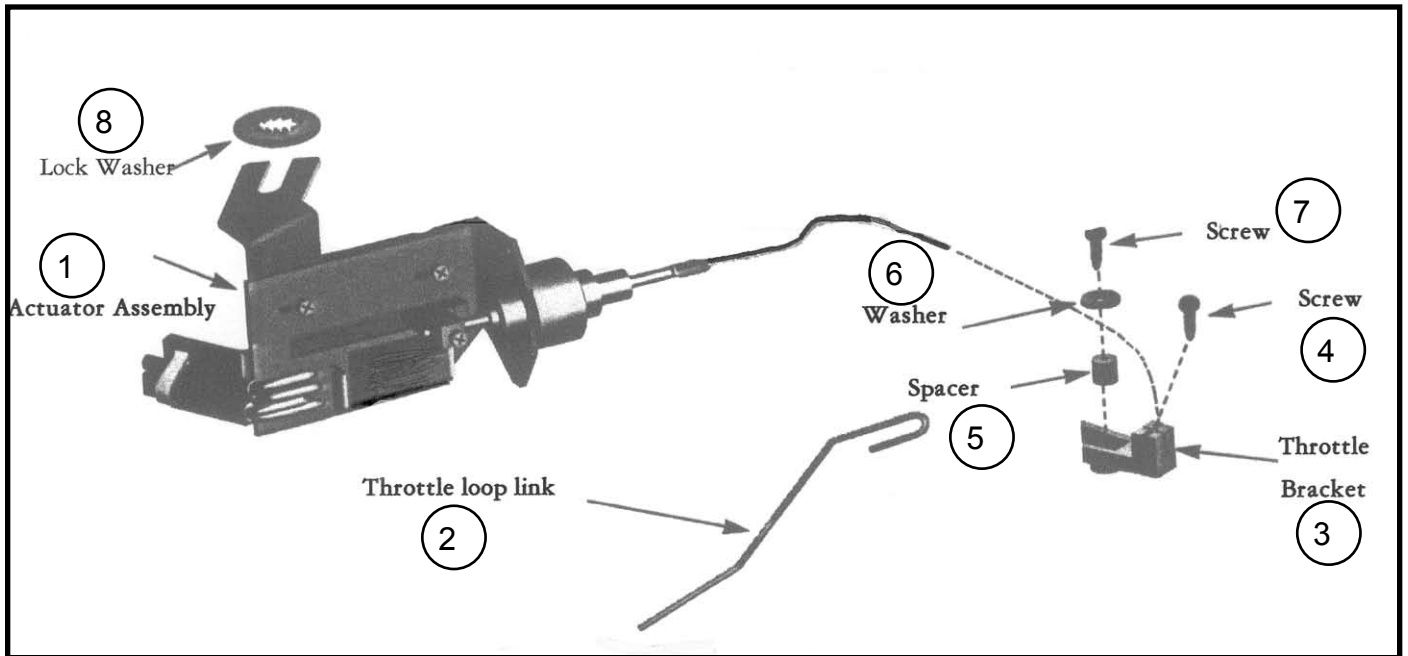

ITEM	PART NUMBER	DESCRIPTION	QTY
1	130-0029-01	Throttle Actuator Assembly	1
2	301-0003-00	Rod, Stainless Steel	1
3	370-0059-00	Bracket, Throttle, 8hp Honda	1
4	310-0004-04	Screw, Machine, 4040, PPH, SS	1
5	380-0015-00	Spacer, 3/16" Tall x .125 ID	1
6	310-0040-23	Washer, Nylon #4 .25 OD	1
7	310-0004-10	Screw, Machine #4 - 40 x 5/8 Phillips	1
8	310-0073-06	Washer, Locking, Internal	1

Step One: Remove Throttle Rod

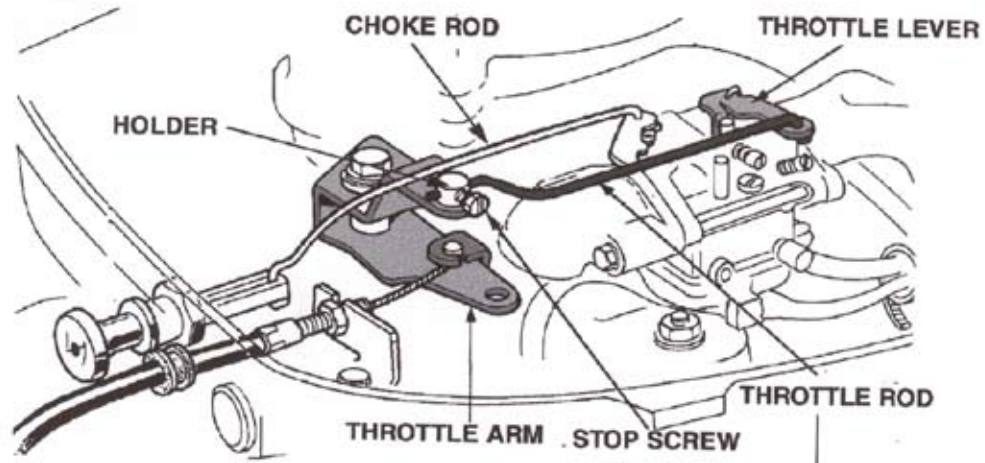

Loosen the stop screw.

Using the tiller grip, rotate the throttle arm until the throttle rod is free from the holder on the throttle arm. Lift the throttle rod and remove it from the throttle lever.

Step Two: Install the throttle bracket

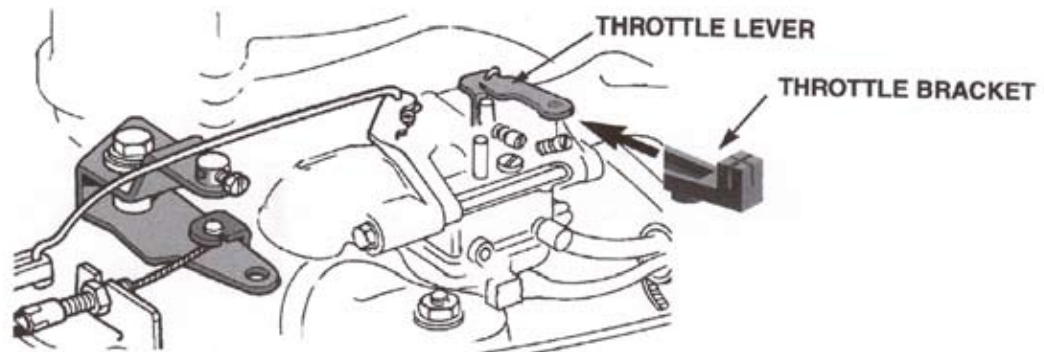

Slide the throttle bracket under the throttle lever.

Secure the throttle bracket to the throttle lever using the 4-40 x 9/16 phillips head screw and the 1/4 inch diameter spacer and the washer.

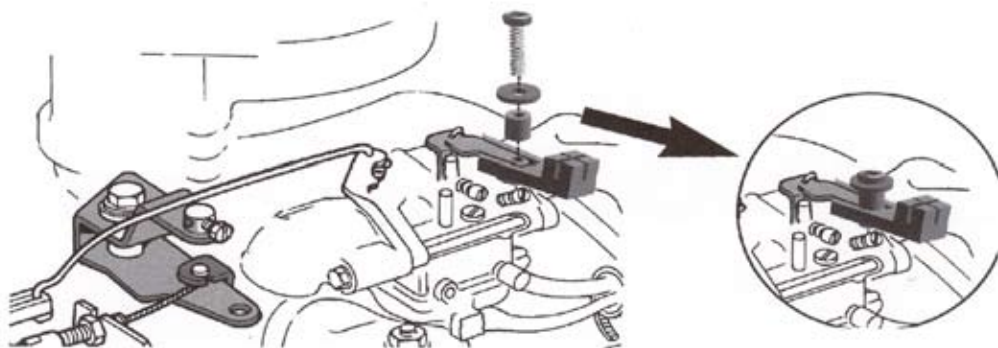

Step Three: Install the throttle loop link

Hook the loop end of the throttle loop link around the spacer on the throttle bracket.

Using the tiller grip, rotate the throttle arm and place the other end of the throttle loop link into the holder on the throttle arm.

With the tiller handle set to idle or full slow position, adjust the throttle loop link so that there is approximately 1 mm clearance between the inside edge of the loop and the spacer on the throttle bracket. While holding the loop flat against the throttle bracket tighten the stop screw.

Rotate the tiller handle from idle to max throttle and verify that the throttle loop link does not bind anywhere. With the tiller handle set to idle, rotate the throttle bracket with your finger from idle to maximum throttle and verify it does not bind on the throttle loop link. If any binding occurs, readjust the stop screw.

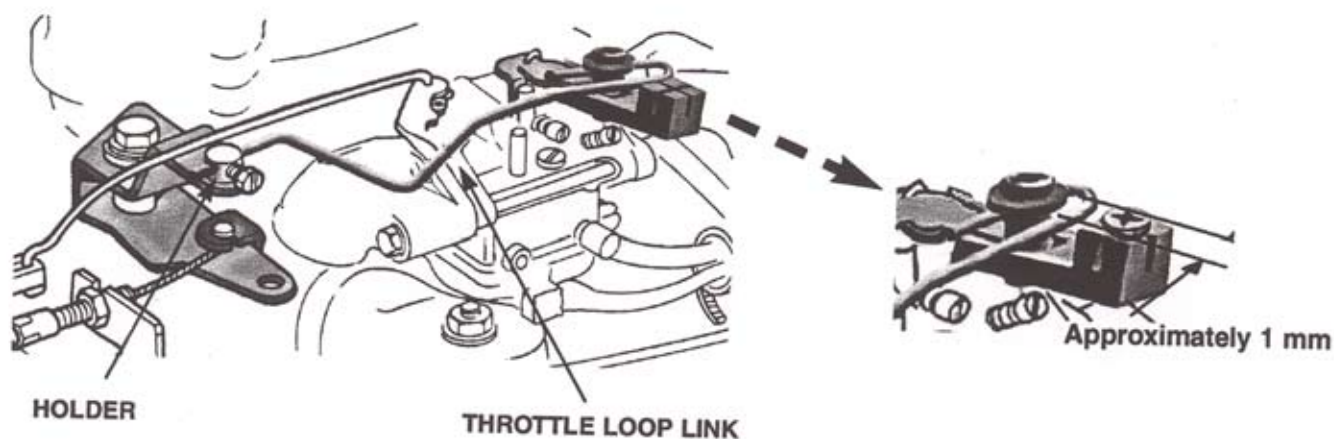

Step Four: Install the throttle actuator assembly

Verify that the outside edge of the stop block is approximately flush with the end of the motor lead screw. If not, loosen the stop block set screw and slide the stop block to the end of the shaft. Retighten the set screw. Push the motor lead screw until the stop block activates (closes) the limit switch. The inner edge of the stop block should be almost in contact with the motor. If necessary, loosen the circuit board mounting screws and slide the circuit board forward or backward to allow the stop block to activate the limit switch properly.

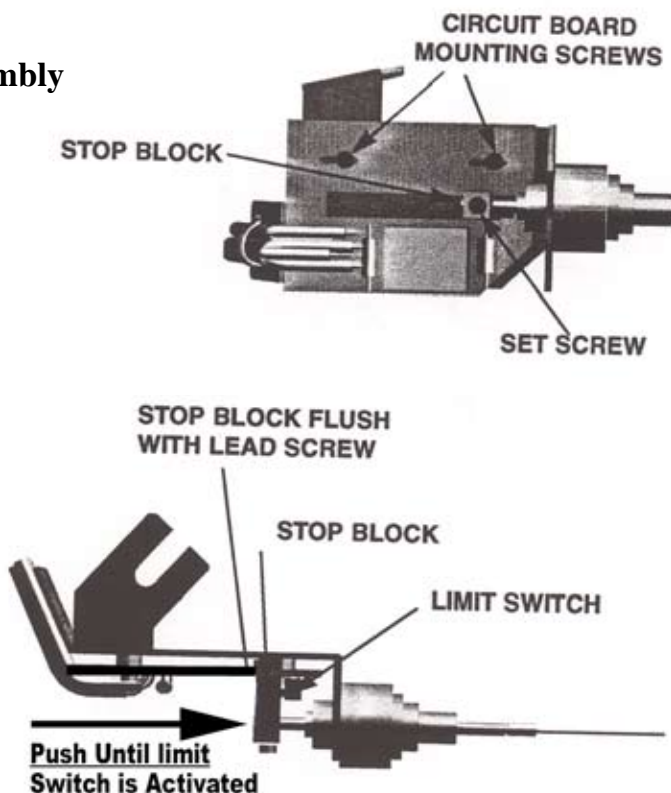

Remove one of the bolts holding down the recoil starter.

Place the lock washer on the bolt and restart it in the mounting hole.

Place the flange of the actuator assembly under the lock washer and tighten the bolt. The motor lead screw should point just outside the outer edge of the square block on the end of the throttle bracket.

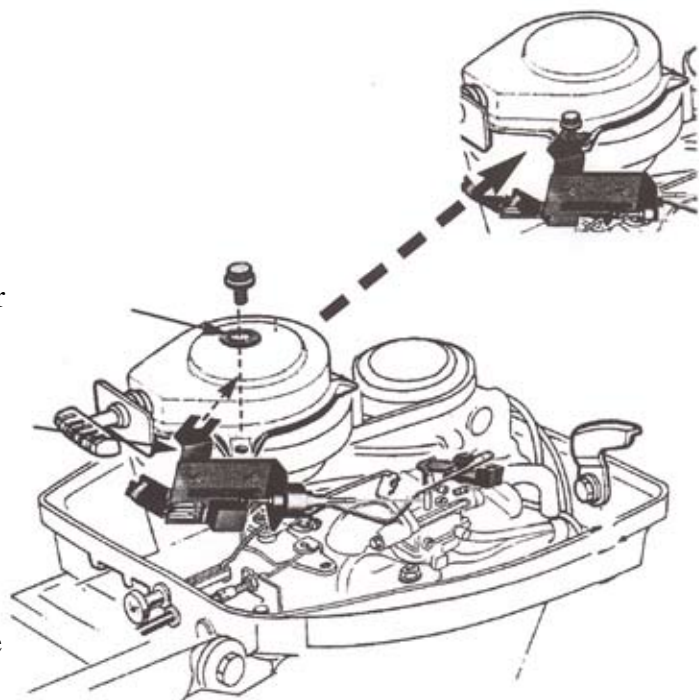

With the motor lead screw fully extended rotate the throttle bracket with your finger to verify that it clears the motor lead screw. If it does not, loosen the bolt and reposition the actuator assembly.

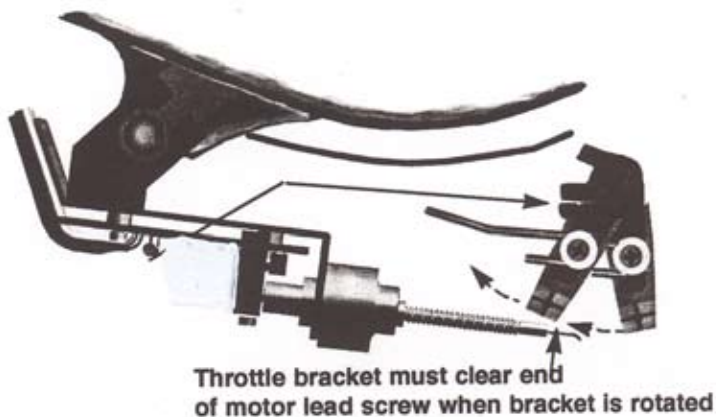

Make sure the tiller grip is set to idle and that the carburetor throttle lever is against the throttle idle adjust screw.

With a slight loop in the throttle pull line between the motor and the throttle bracket, place the pull line in the slot of the throttle bracket and wrap it around the bracket and in the slots twice. Place the lock screw in the throttle bracket and tighten to secure the pull line.

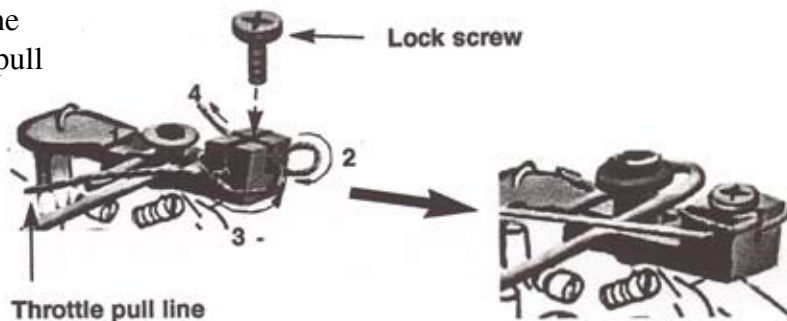

Testing the Actuator Functions:

Please refer to the startup section of your owner's manual before operating your handheld and running the throttle actuator.

- 1. With the outboard in the water, or with a proper coolant flush device connected, start the outboard and let it warm up to operating conditions. Be prepared to kill the outboard ignition if the idle speed is too high when the engine starts.**
- 2. With the outboard in idle position make sure there is proper slack in the pull string on the throttle actuator. If the motor does not go to idle, reposition the string by loosening the pinch screw on the brass pivot.**
- 3. Using the UP ARROW button on the Handheld verify that the engine rpm's go up. Using the IDLE/RESUME button on the handheld verify that the engine returns to idle. Check the throttle up and down several times along with the idle/res and verify that you don't have any problems.**