

TOYOTA

# HOW TO UPDATE YOUR MAPS

#1

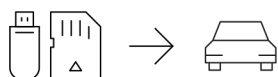

#2

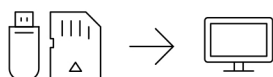

#3

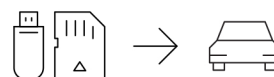

# Map Update Portal Requirements

- This portal is available to Windows and MAC systems only;  
**Tablets and Mobile devices are not supported**
  - Windows
    - Windows 7 SP1 or newer, Microsoft .NET 4.5 (included)
    - 1024 x 768 display, USB port and 1 GB RAM
    - High speed Internet access (Not for use with dial-up, mobile or satellite connections)
    - May require up to 20 GB free disk space
  - Mac
    - OS X 10.11 or newer
    - 1440 x 900 display, USB port and 1 GB RAM
    - High speed Internet access (Not for use with dial-up, mobile or satellite connections)
    - May require up to 20 GB free disk space

# Step 1

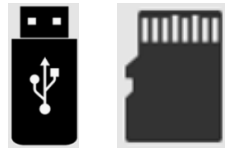

## Prepare a Micro SD card or USB drive

- Prepare a Micro SD card or USB drive with storage **above 4GB**, and format the Micro SD card or USB drive , following the steps below
- ① Computer → ② Right click on the Micro SD card or USB drive icon → ③ Click Format  
→ ④ Click Start (Screen shot was taken from a Windows 8 system)

\*Note: If you would like to update another vehicle with the same card, the card has to be formatted again

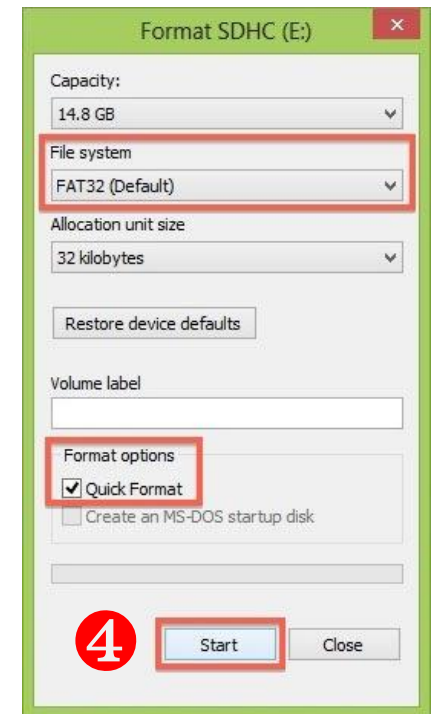
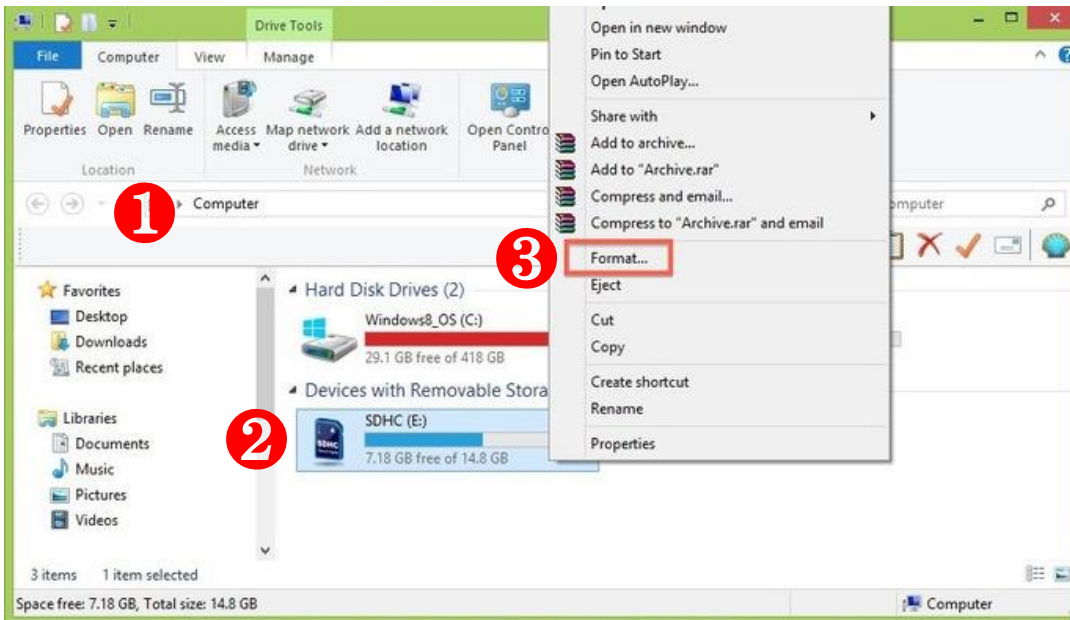

# Step 2



## Prepare your vehicle

- Switch your vehicle to “**ENGINE ON**” until the navigation system enters the CAUTION page
- Touch the Agree button and continue to the main page

\*Note: Keep the Engine on throughout Step 2 to Step 2.3

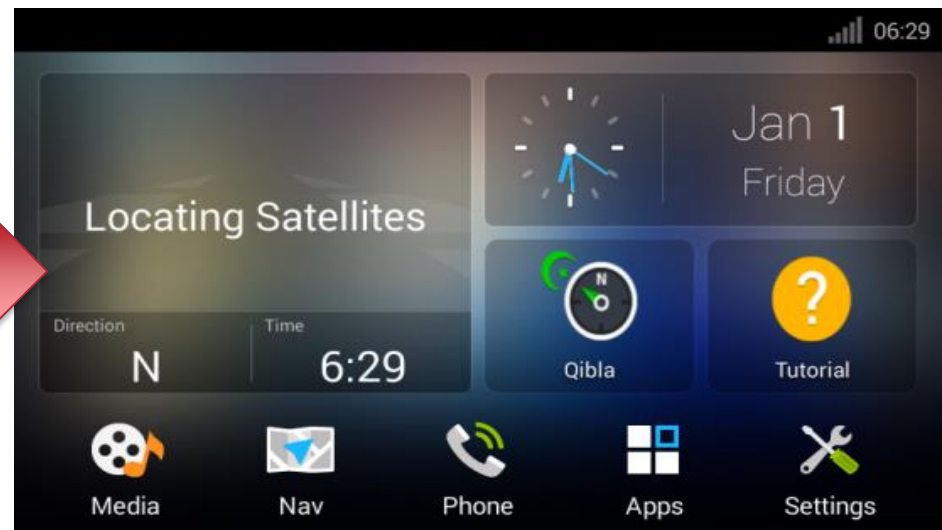
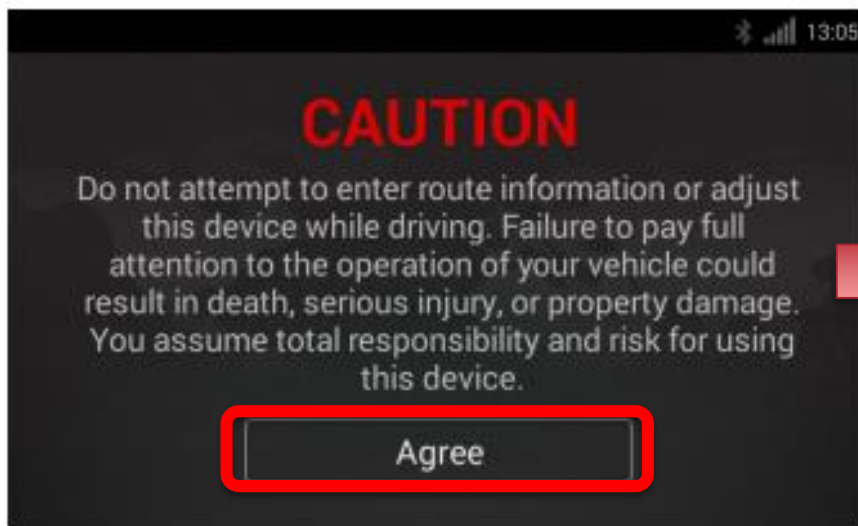

# Step 2.1 for Micro SD card model

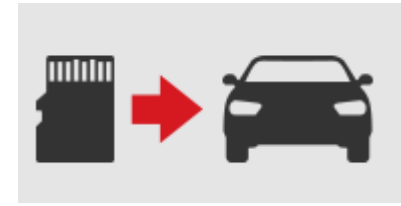

## Create a Map Update Card

- Insert the formatted Micro SD card to the slot on your navigation system
- Followings are the Navigation Systems adapted with Micro SD card



**7" Navigation System**  
Insert Micro SD card  
with metal part facing  
**LEFT**



**9" Navigation System**  
Insert Micro SD card  
with metal part facing  
**RIGHT**



# Step 2.1 for USB model

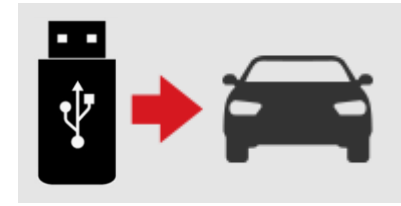

## Create a Map Update USB

- Insert the formatted USB drive to the USB port on your navigation system
- Followings are the Navigation Systems adapted with USB drive



\* Note: This model's USB port is not located at the navigation system

# Step 2.2



## Create a Map Update Card

- Go to Settings → System → touch “Update” on your navigation system

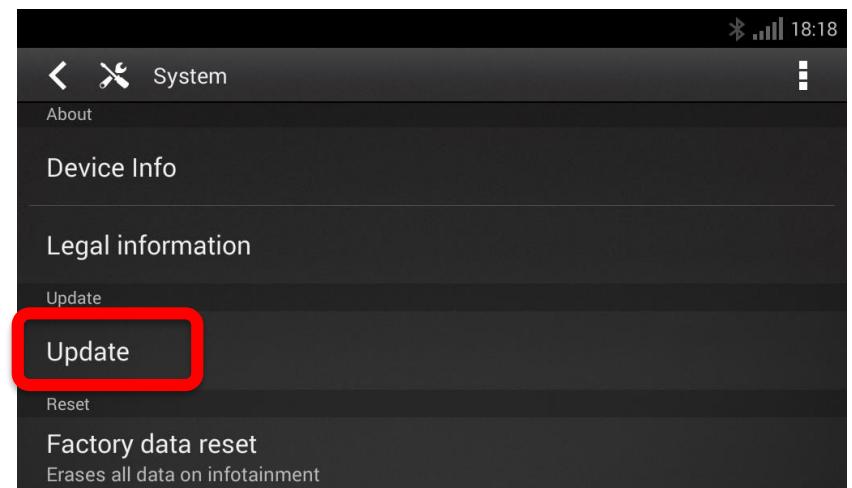
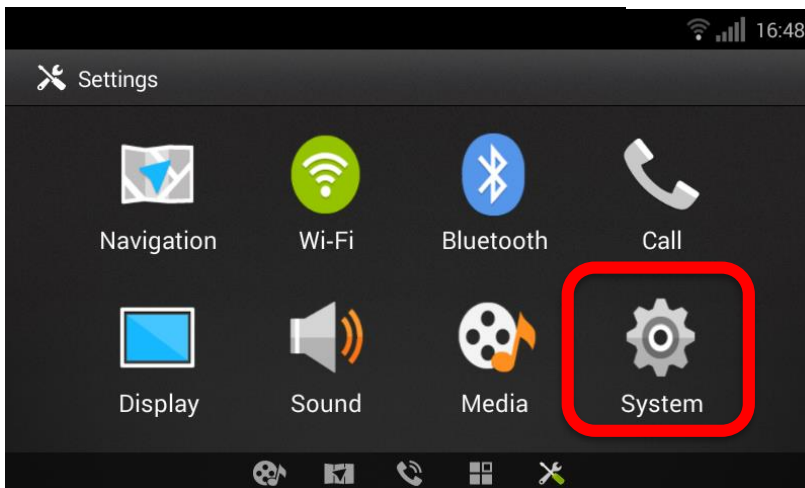
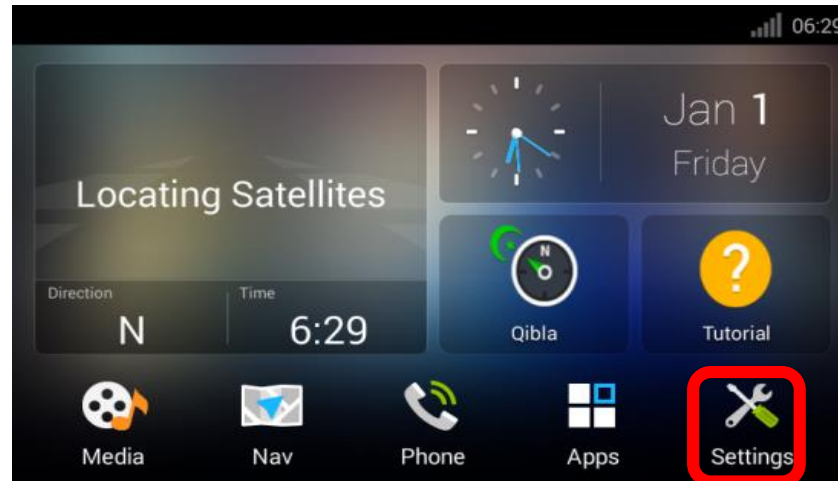

# Step 2.3



## Create a Map Update Card

- Touch “Create Card” on Screen ① and touch “OK” on Screen ②
- \*Note: Do not remove Micro SD card or USB drive from the vehicle until you see Screen ②
- Remove Micro SD card or USB drive from the vehicle and bring it to the computer

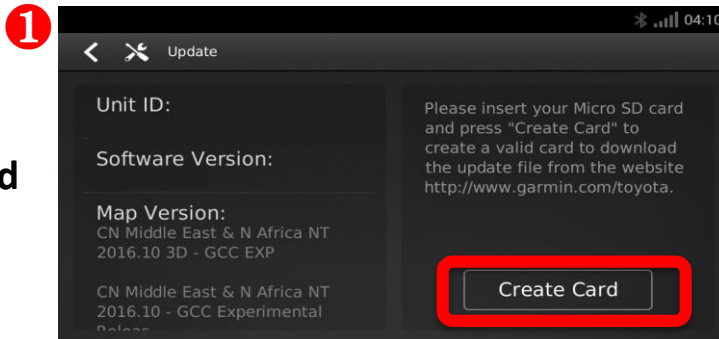

Micro SD card  
Model

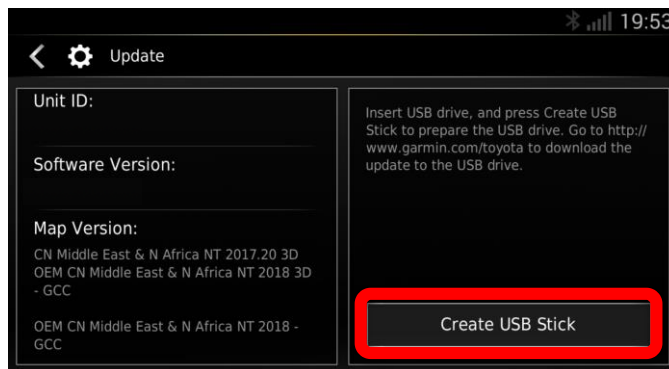

USB Drive  
Model

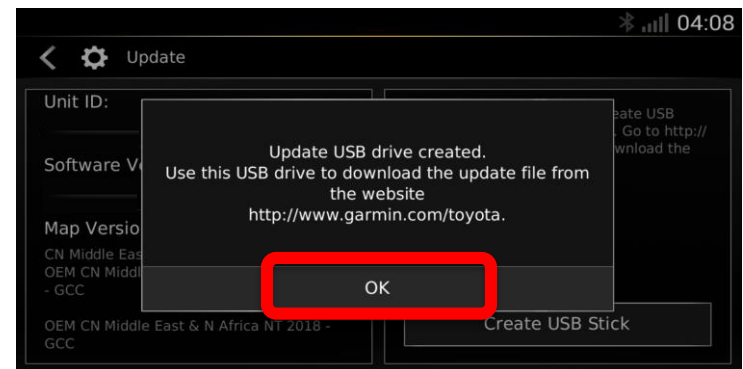



# Step 3



## Download Garmin Express to your computer

- If you already have Garmin Express installed to your computer, make sure to update Garmin Express to **4.1.12.0 or above** versions
- Check versions by clicking  → **About** → [Check for Updates to Express](#)
- Continue to [Step 4](#) if the version is the latest

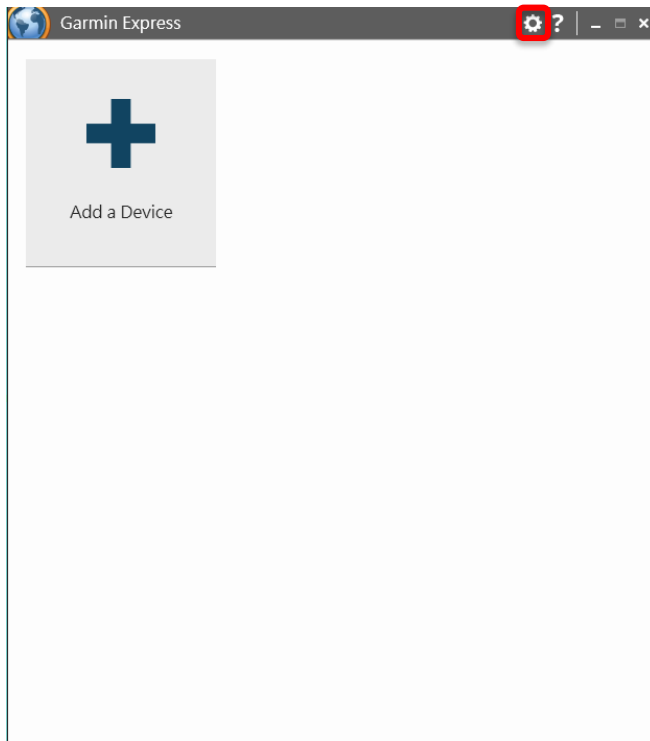

# Step 3.1



## Download Garmin Express to your computer

System requirement of Garmin Express

### — Windows

- Windows 7 SP1 or newer, Microsoft .NET 4.5 (included)
- 1024 x 768 display, USB port and 1 GB RAM
- High speed Internet access (Not for use with dial-up, mobile or satellite connections)
- May require up to 20 GB free disk space

### — Mac

- OS X 10.11 or newer
- 1440 x 900 display, USB port and 1 GB RAM
- High speed Internet access (Not for use with dial-up, mobile or satellite connections)
- May require up to 20 GB free disk space

## Step 3.2

### Download Garmin Express to your computer

- Click the link on the web portal to start download

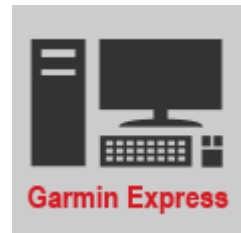
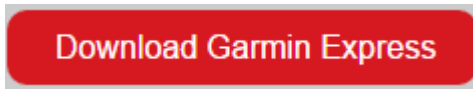

Your download will begin automatically. If it doesn't, you can [restart the download](#).

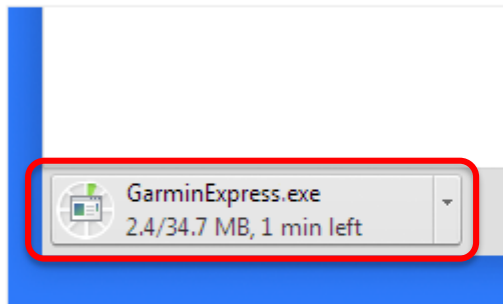

1 Download

After downloading the file, click on the file name.



2 Install

Click "Install" to begin installing Express.

## Step 3.3

### Download Garmin Express to your computer

- Installation will start automatically

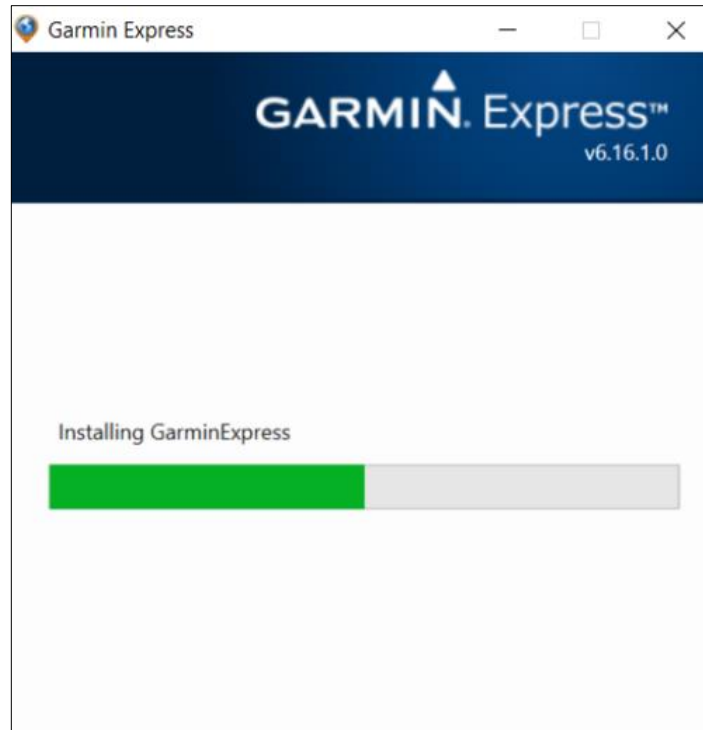

# Step 4



## Activate Garmin Express on your computer

- Click **Launch Garmin Express** on the Installation Complete window
- Insert Micro SD card or USB drive into the computer, then click “Add a Device”

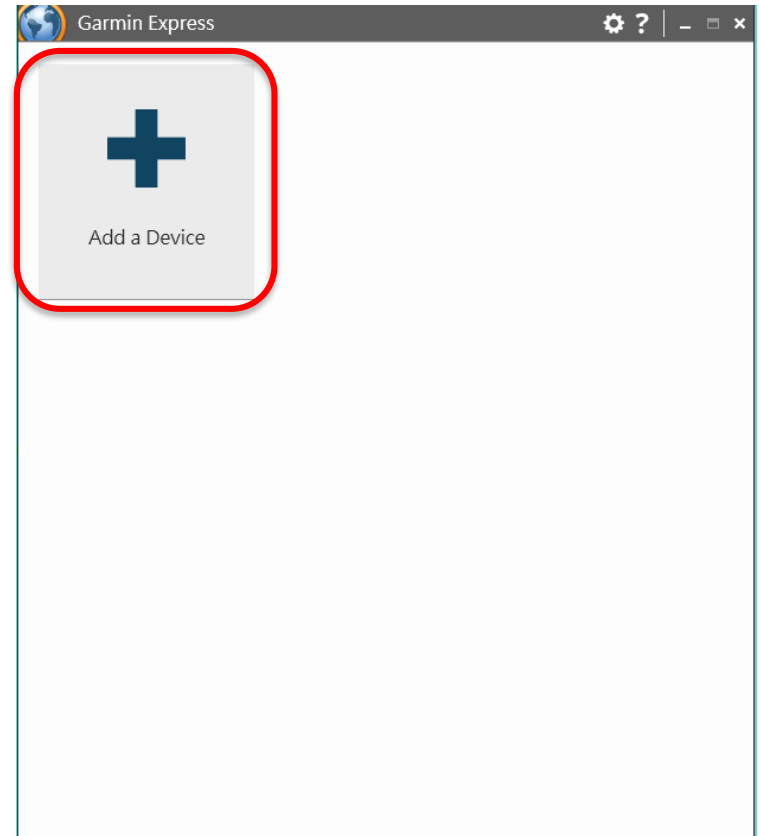
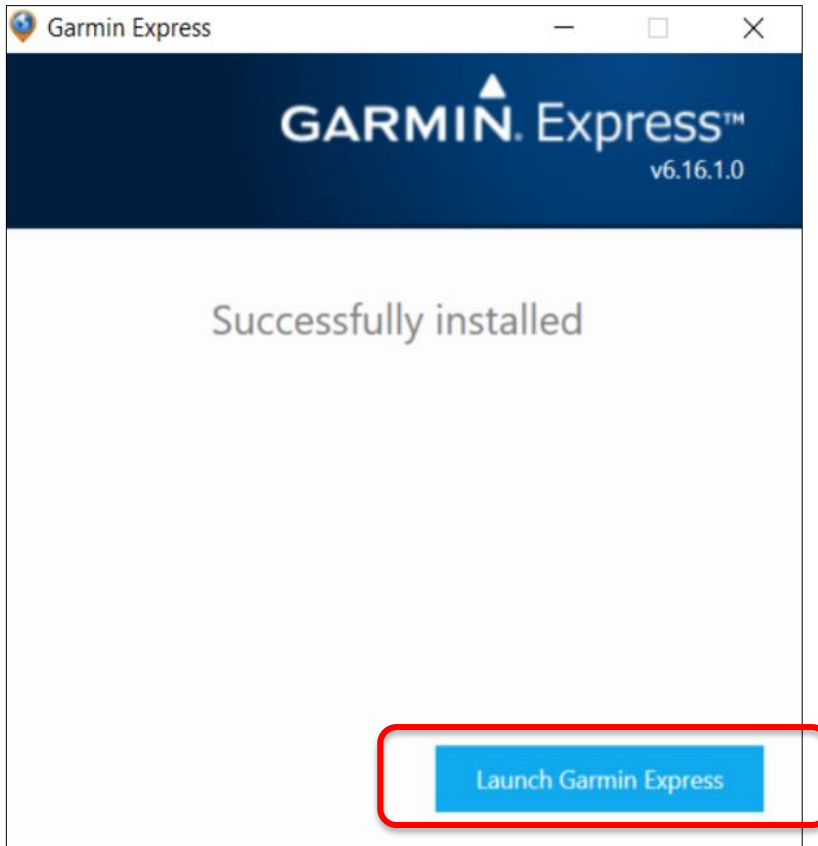

# Step 4.1



## Garmin Express recognizes the Micro SD card or USB drive

- The Micro SD card or USB drive will be recognized automatically
- Click **Add Device** when the “Device Found” message is shown

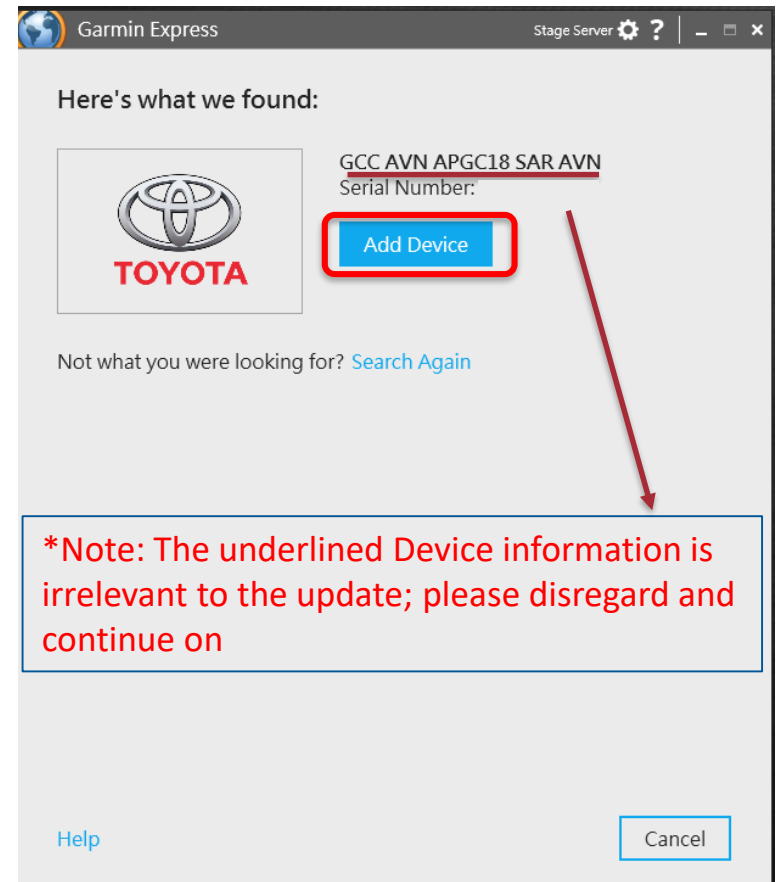
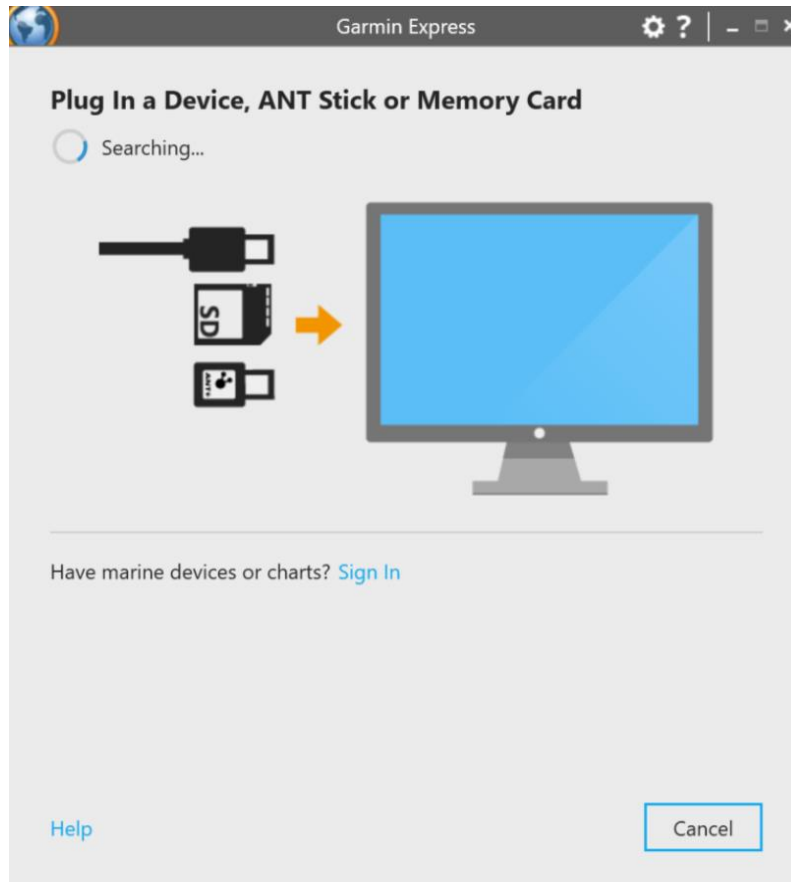

**\*Note: The underlined Device information is irrelevant to the update; please disregard and continue on**

# Step 4.2

## Go through the set up process on Garmin Express

- Product Registration is NOT required to complete map update
- Nickname can use the default or input 1 to 20 characters in the case of English



Garmin Express

Home TOYOTA GCC AVN APGC18 SAR AVN Connected

Register Nickname

### Product Registration

To register this device now, simply provide your email address. Registration is optional. You can always register later if you decide to skip this step now.

Hint: If you have a Garmin account, use the same email address here.

### Map Update Notifications

☐ Email me when a map update is available.

**\*Note: The Registration is irrelevant to the update; please disregard and continue on.**

Next

Garmin Express

Home TOYOTA GCC AVN APGC18 SAR AVN Connected

Register Nickname

### Add a Nickname

You can add a nickname to this device to make it easier to identify when viewing it in Garmin Express. This can be especially helpful when you have multiple devices.

e.g. "My GPS" or "Mom's navigator"

Next

# Step 5



## Check Map Update Status

- (Case1 : Free Update expired) Click “See Pricing” to proceed, and go to [step 5.1](#).
- (Case2 : Free Update) Click “Install” to proceed, and go to [step 6](#).
- (Case3) Your map is the latest version; there is no need to update.

### Case1

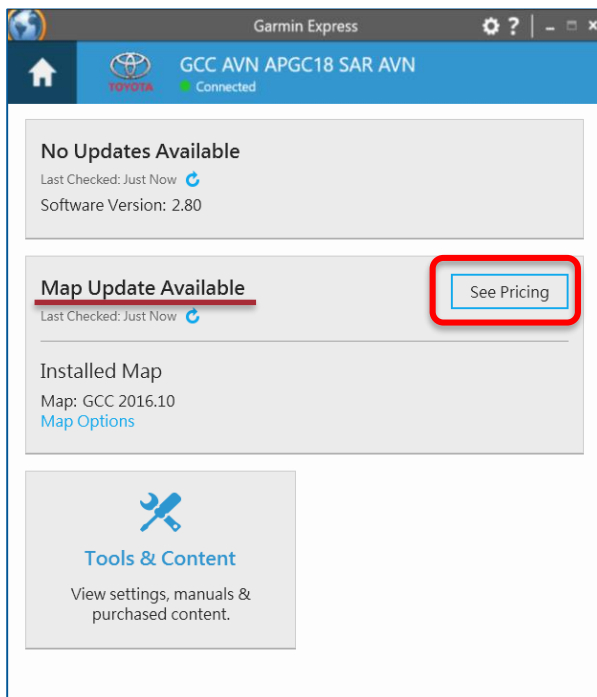

### Case2

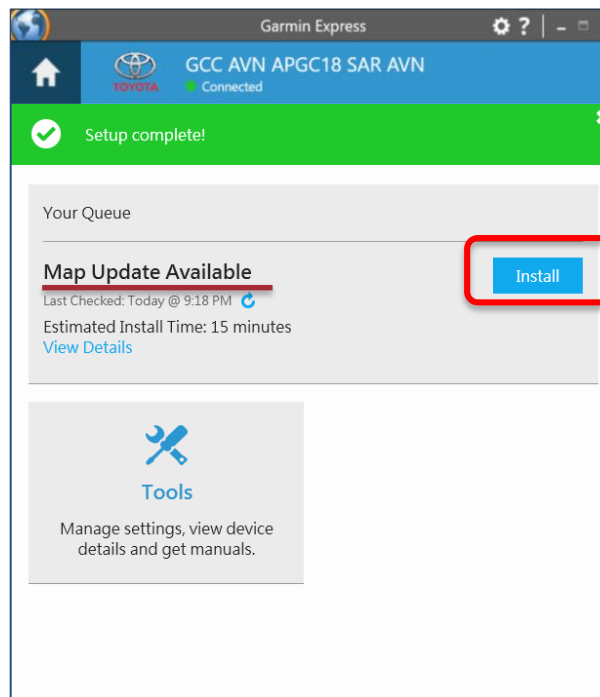

### Case3

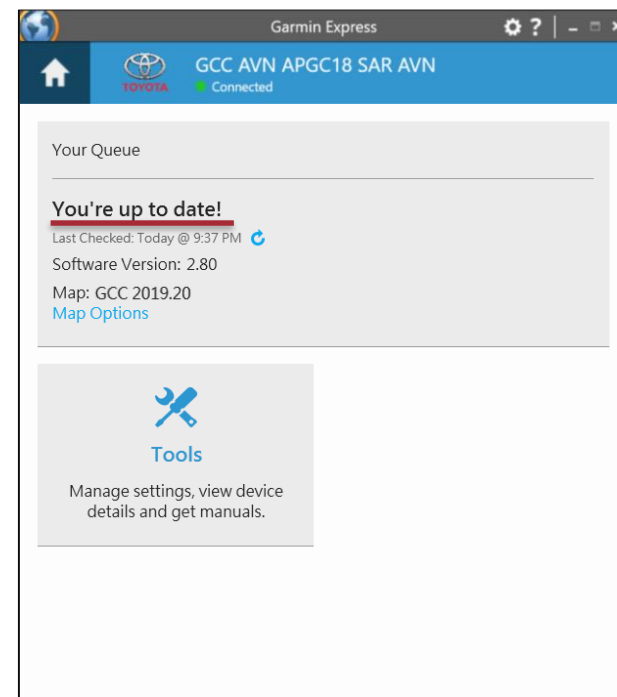



# Step 5.1

## Select Locale

- Select Your Location to proceed

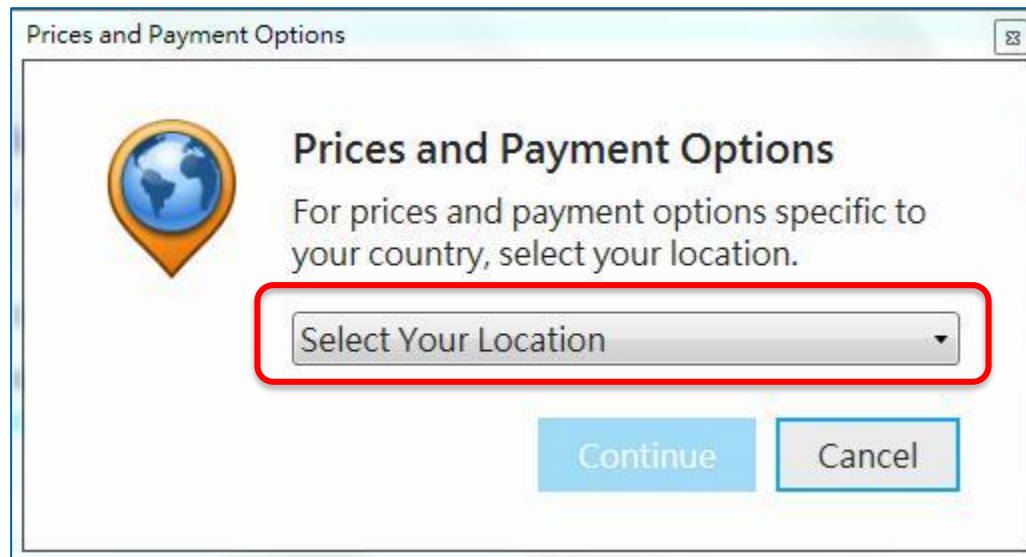

# Step 5.2

## Map Update Options

- Click the Pricing to proceed

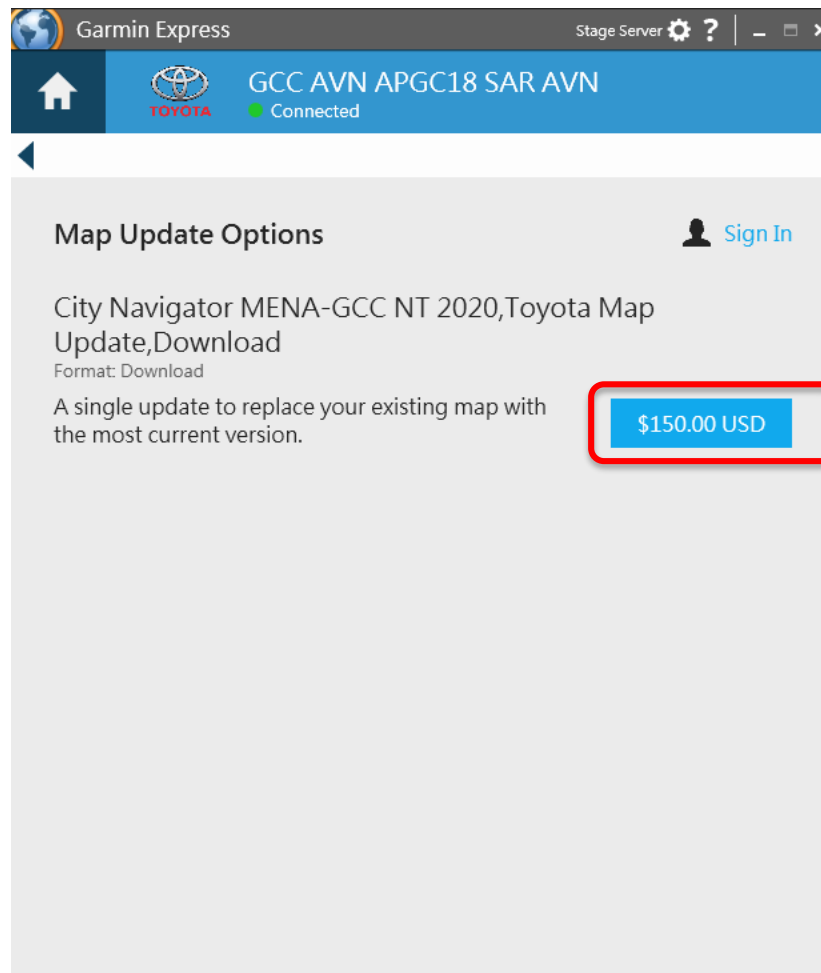

## Step 5.3

### Accept the Trading Terms

- Select “Accept” to proceed



# Step 5.4

## Sign in

- Sign in with a Garmin or alternative account



Garmin Express

Purchasing: City Navigator MENA-GCC NT 2020,Toyota Map Update,Download for Your GCC AVN APGC18 SAR AVN Cance

Sign In Check Out Receipt

Email

Password [\(Forgot?\)](#)

[Sign In](#)

Don't have an account? [Create One](#)

# Step 5.5

## Input Address

- Enter info in the required field and click “Continue”



Garmin Express

Purchasing: City Navigator MENA-GCC NT 2020,Toyota Map Update,Download for Your GCC  
AVN APGC18 SAR AVN Cancel

☒ Sign In ☐ Check Out ☐ Receipt

- ☐ FirstName Tester LastName Tester , 14 HASBROUCK DR, FRANKLIN PARK, NJ 08823-1826 [Edit](#)
- ☐ First Name Second name, TEST ADDRESS, TEST CITY, ABD TEST ZIP [Edit](#)
- ☐ FirstName Tester LastName Tester , 14 HASBROUCK DR, FRANKLIN PARK, NJ 08823 [Edit](#)
- ☐ FirstName Tester LastName Tester , 14 HASBROUCK DR, FRANKLIN PARK, NJ 08823-1826 [Edit](#)
- ☐ FirstName Tester LastName Tester , 14 HASBROUCK DR, FRANKLIN PARK, NJ 08823-1826 [Edit](#)
- ☐ FirstName Tester LastName Tester , 14 HASBROUCK DR, FRANKLIN PARK, NJ 08823-1826 [Edit](#)
- ☐ FirstName Tester LastName Tester , 14 HASBROUCK DR, FRANKLIN PARK, NJ 08823-1826 [Edit](#)
- ☐ FirstName Tester LastName Tester , 14 HASBROUCK DR, FRANKLIN PARK, NJ 08823-1826 [Edit](#)
- ☐ Add New Address

Item Subtotal: **\$150.00 USD**

**CONTINUE**

# Step 5.6

## Confirm Billing Information

- Confirm Shipping / Billing Address info
- Click Continue to proceed



Garmin Express

Purchasing: City Navigator MENA-GCC NT 2020,Toyota Map Update,Download for Your GCC AVN APGC18 SAR AVN Cancel

Sign In Check Out Receipt

### Billing Information

Shipping Address [Edit](#)

FirstName Tester LastName Tester  
US  
14 HASBROUCK DR  
FRANKLIN PARK, NJ 08823-1826  
1 0005551212

Billing Address

- FirstName Tester LastName Tester , 14 HASBROUCK DR, FRANKLIN PARK, NJ 08823-1826 [Edit](#)
- FirstName Tester LastName Tester , 14 HASBROUCK DR, FRANKLIN PARK, NJ 08823-1826 [Edit](#)
- First Name Second name, TEST ADDRESS, TEST CITY, ABD TEST ZIP [Edit](#)

Garmin Express

Purchasing: City Navigator MENA-GCC NT 2020,Toyota Map Update,Download for Your GCC AVN APGC18 SAR AVN Cancel

Sign In Check Out Receipt

Payment Method

☒ Credit Card



*You will be directed to the Credit Card website after reviewing your order.*

Item Subtotal: \$150.00 USD  
Estimated Tax: \$9.94 USD  
Estimated Order Total: **\$159.94 USD**

You will have a chance to review your order before you place it.

**CONTINUE**

# Step 5.7

## Order Review

- Review order info and click “Continue” to proceed



Garmin Express

Purchasing: City Navigator MENA-GCC NT 2020,Toyota Map Update,Download for Your GCC  
AVN APGC18 SAR AVN Cancel

Sign In Check Out Receipt

### Order Review

**CONTINUE TO PAYMENT**

<b>Shipping Address</b> <a href="#">Edit</a>	<b>Billing Address</b> <a href="#">Edit</a>	<b>Payment Information</b> <a href="#">Edit</a>
FirstName Tester LastName Tester US 14 HASBROUCK DR FRANKLIN PARK, NJ 08823-1826 1 0005551212	FirstName Tester LastName Tester US 14 HASBROUCK DR FRANKLIN PARK, NJ 08823-1826 1 0005551212	Payment Method: Credit Card

Items in Your Order	Quantity	Price Each
City Navigator MENA-GCC NT 2020,Toyota Map Update,Download	1	\$150.00 USD

# Step 5.8

## Payment Information

- Enter Credit Card info and click “Place Secure Order” to proceed

This screenshot shows the Garmin Express payment page. At the top, a blue banner displays the text "Purchasing: City Navigator MENA-GCC NT 2020, Toyota Map Update, Download for Your GCC AVN APGC18 SAR AVN" and a "Cancel" button. Below the banner is a progress bar with three steps: "Sign In" (marked with a green checkmark), "Check Out" (marked with a blue circle), and "Receipt" (marked with a grey circle). The Garmin logo is prominently displayed. Below the logo, there are five steps in a horizontal sequence: "Shipping" (checked), "Billing" (checked), "Review" (checked), "Payment & Place Order" (active, marked with a blue circle), and "Order Confirmation" (marked with a grey circle). Payment logos for Discover, American Express, Visa, and MasterCard are shown. The form includes input fields for "Card Number", "Cardholder's Name", and "Expiration Date".This screenshot shows the same Garmin Express payment page as the previous one, but with the "Payment & Place Order" step active. The "Cardholder's Name" field is filled with "Credit". The "Expiration Date" is set to "10 / 2020". The "CVC" field is filled with "737" and has a "What is this?" link next to it. Below the form, there are two buttons: "BACK TO CART" and "PLACE SECURE ORDER". The "PLACE SECURE ORDER" button is highlighted with a red rectangular border.



# Note

## If encountered blank screen like the below

- Click “Cancel” on the upper right of the window, and start over from Step 5.2

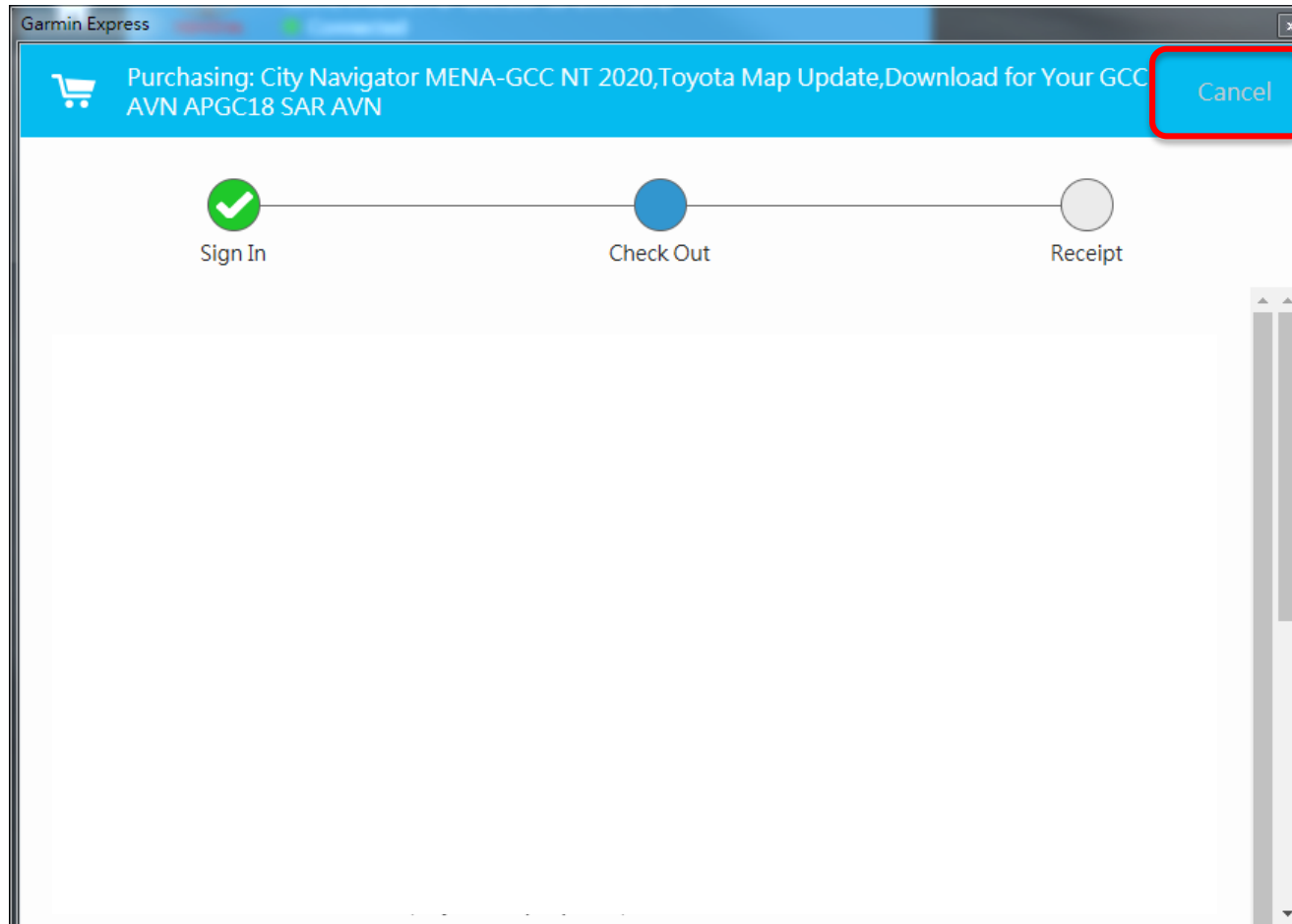

# Step 5.9

## Order Complete

- Select Install Now to proceed

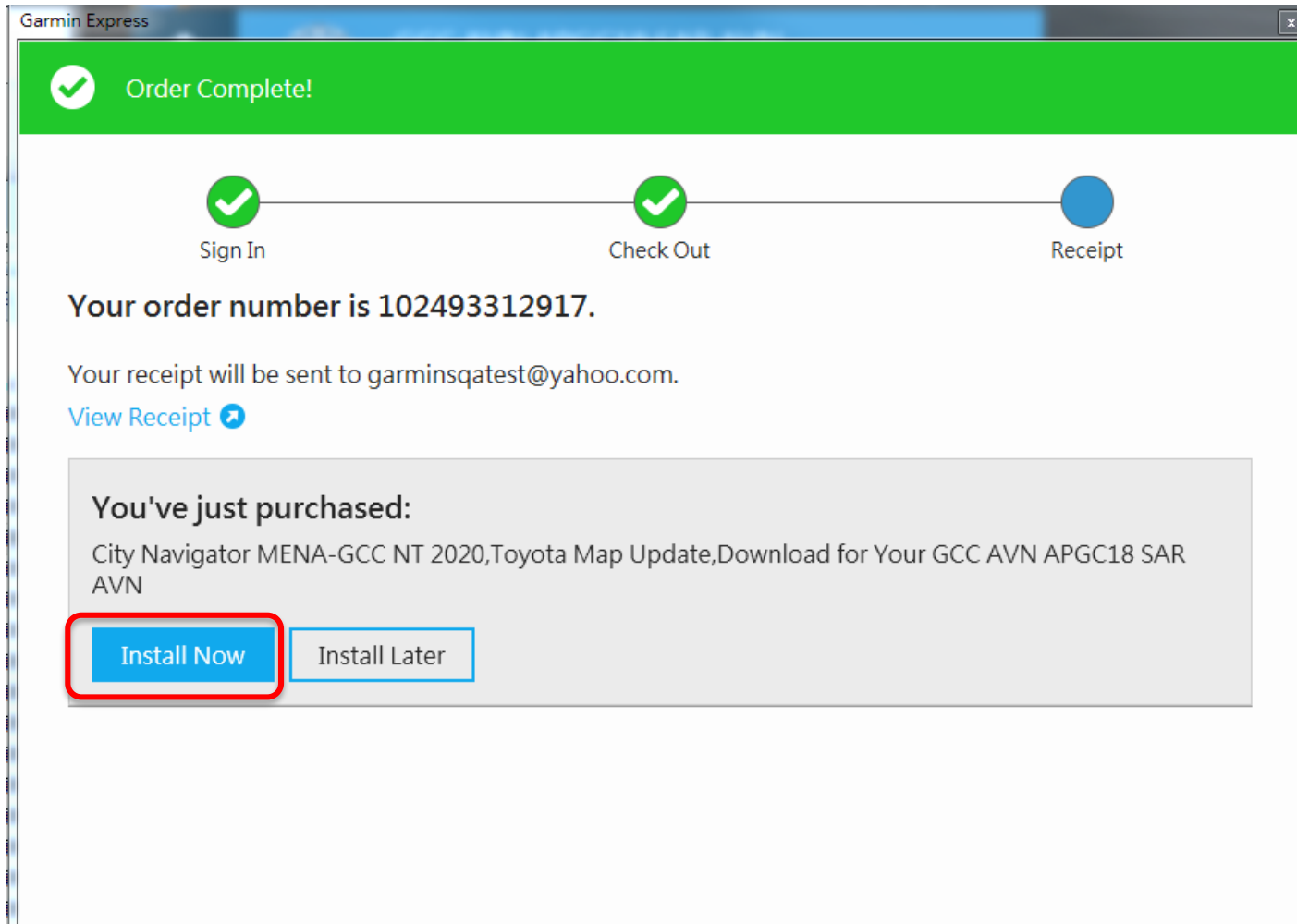

# Step 5.10

## Install Later

- You will see this screen if select “Install Later”
- You can select “Activate” to keep installation



# Step 6

## Map Installation

- Click **Install** then click **Accept**

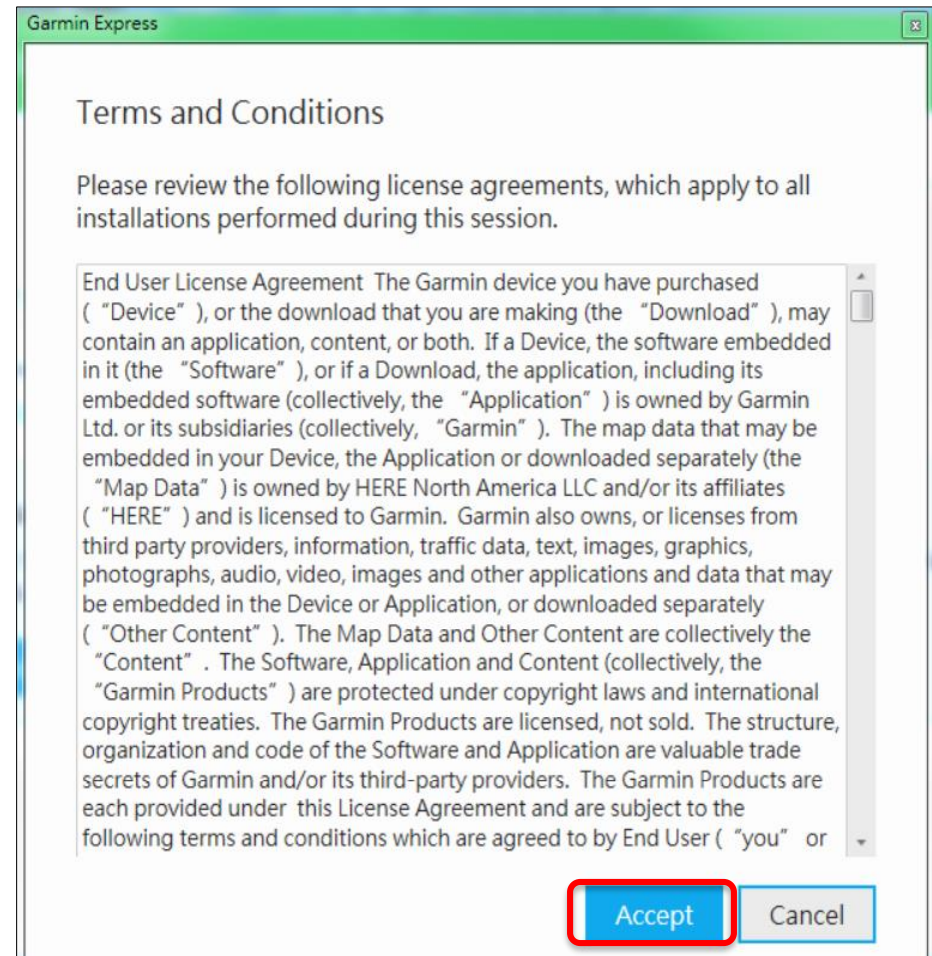
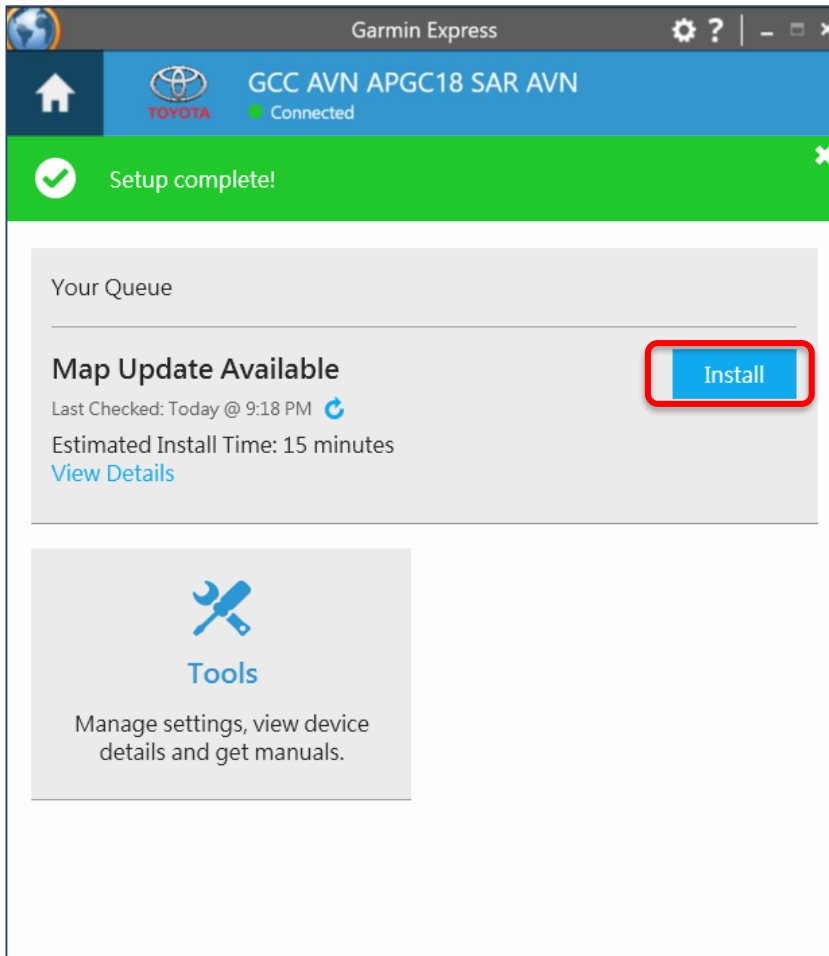

# Step 6.1

## Map Installation

- Click Continue

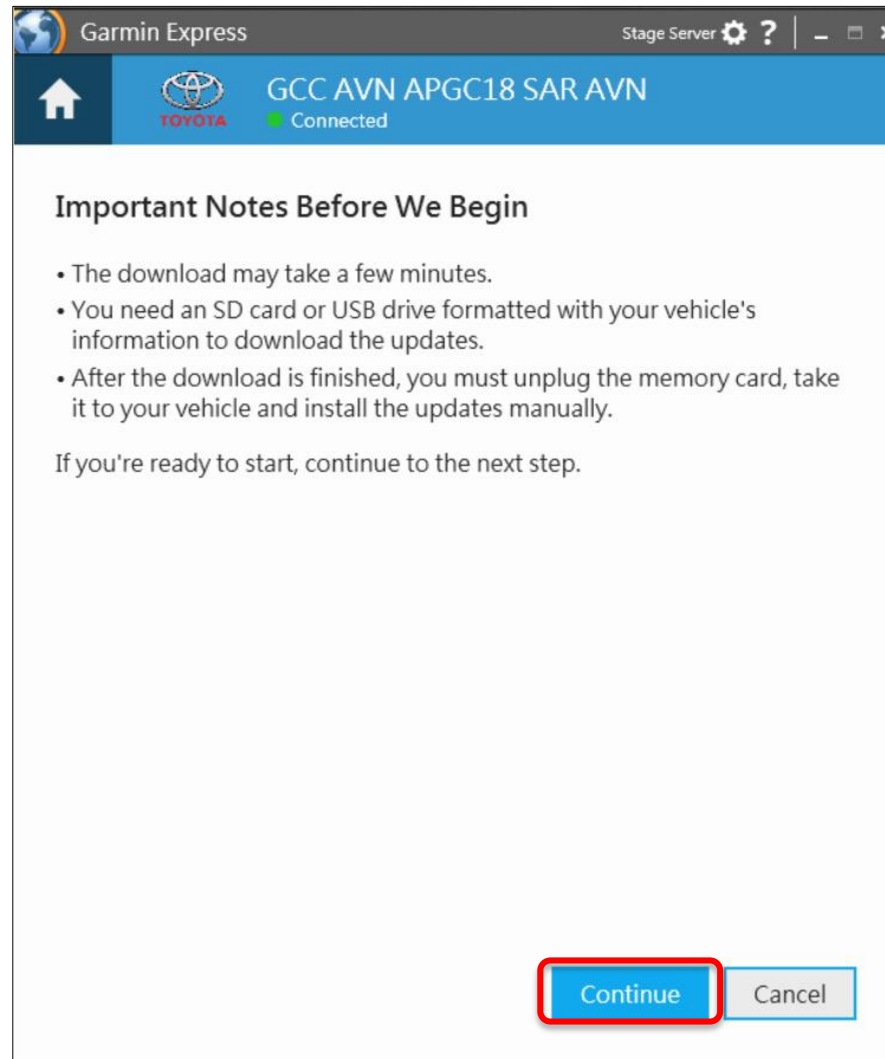

# Step 6.2

## Map installation will start automatically

- Estimated Time Remaining depends on your internet speed

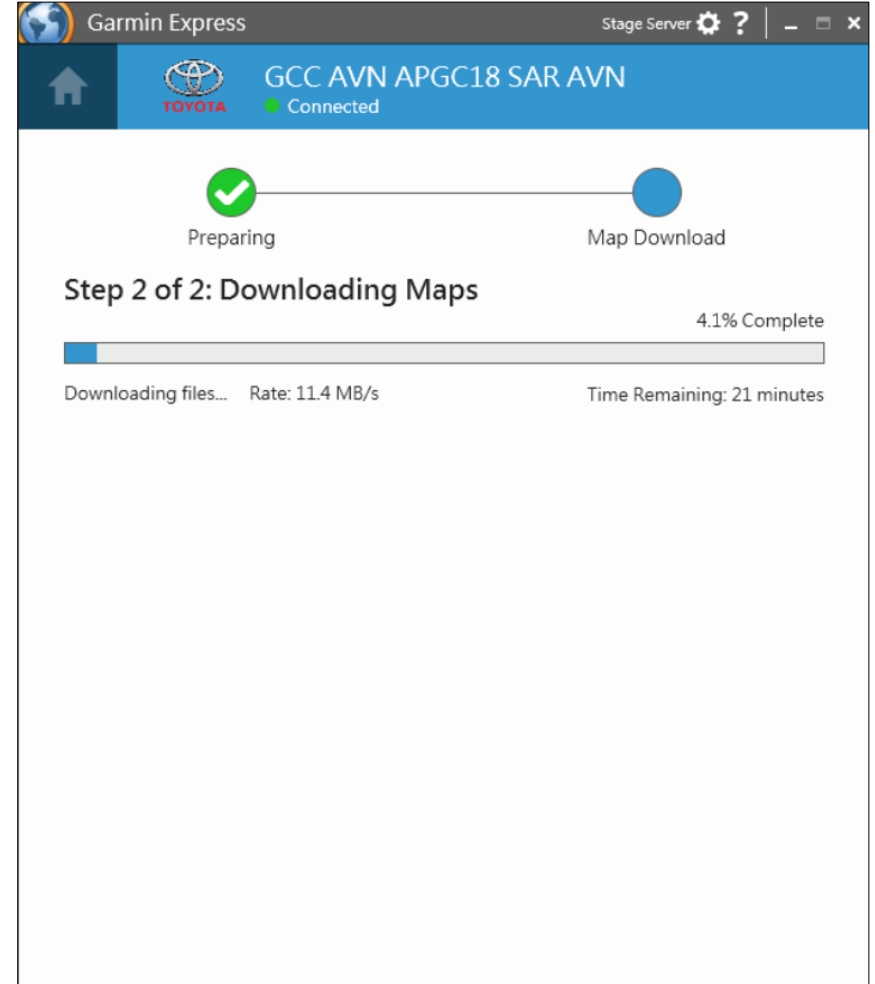
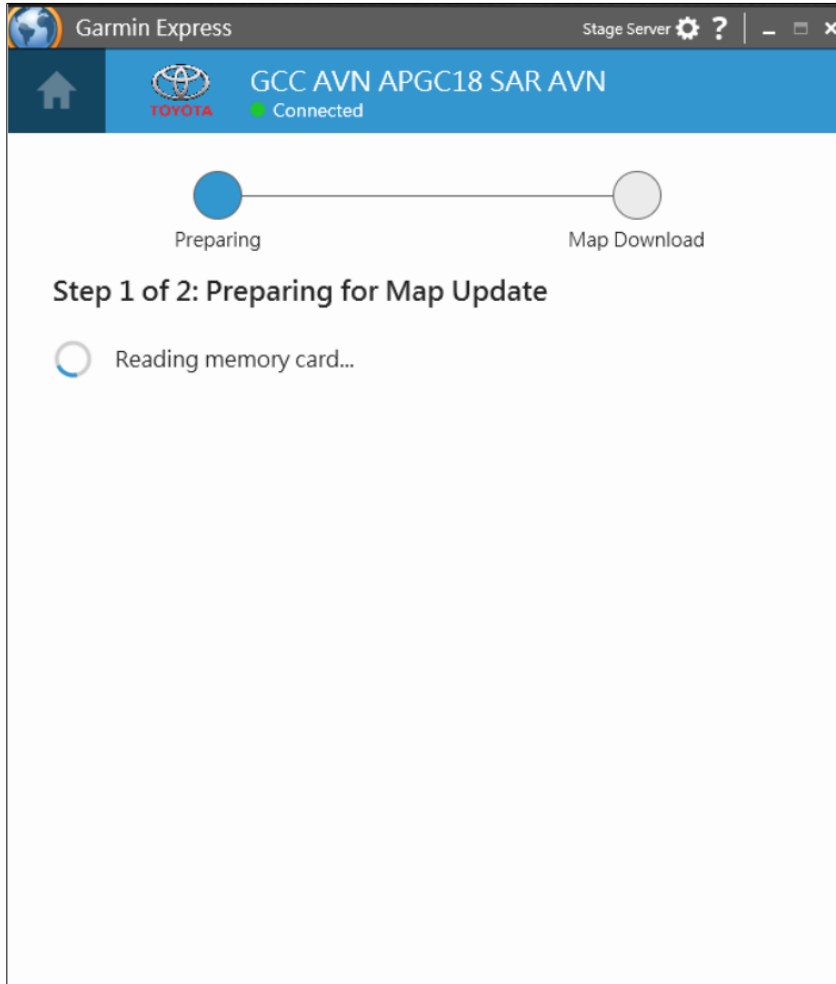

# Step 6.3

## Map installation complete

- Message ① will show if map installation is complete
- Message ② will show if map version is the latest
- Remove the Micro SD card or USB drive from the computer and bring it to the vehicle

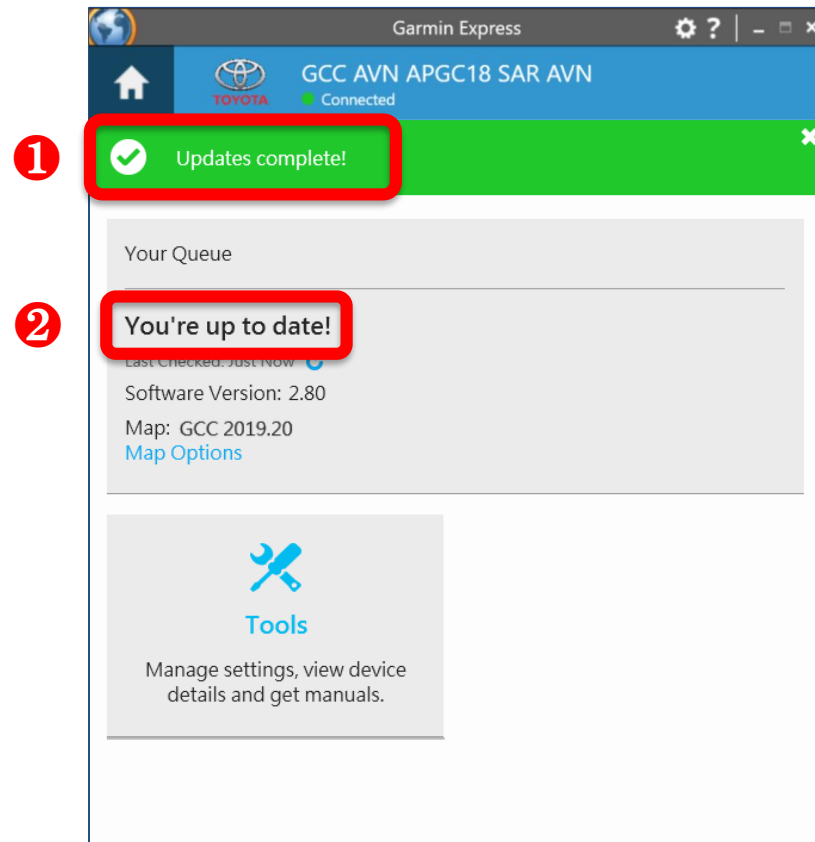

# Step 7



## Prepare your vehicle

- Switch your vehicle to “**ENGINE ON**” until the navigation system enters the CAUTION page
- Touch the Agree button and continue to the main page

\*Note: Keep the Engine on throughout Step 7 to Step 8

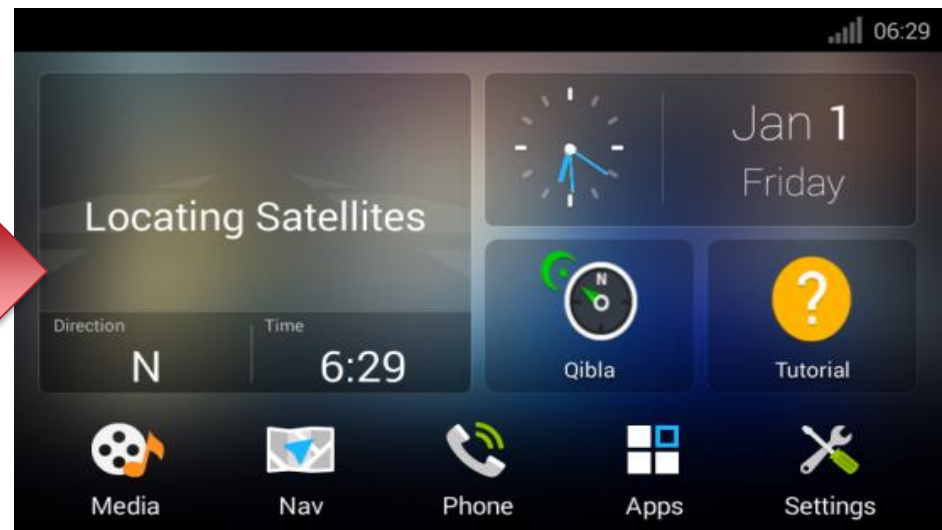
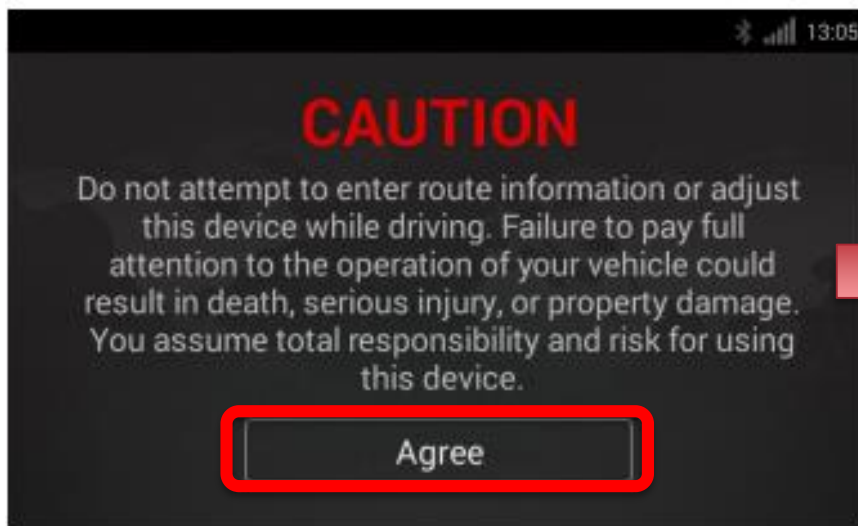



# Step 7.1 for Micro SD card model

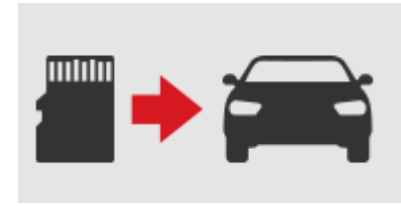

## Ready for update

- Insert the formatted Micro SD card to the slot on your navigation system
- Followings are the Navigation Systems adapted with Micro SD card



**7" Navigation System**  
Insert Micro SD card  
with metal part facing  
**LEFT**



**9" Navigation System**  
Insert Micro SD card  
with metal part facing  
**RIGHT**



# Step 7.1 for USB model

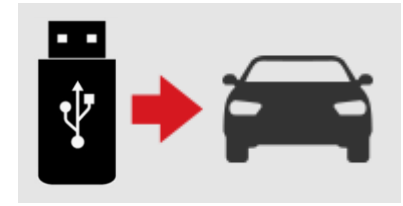

## Ready for update

- Insert the formatted USB drive to the USB port on your navigation system
- Followings are the Navigation Systems adapted with USB drive



\* Note: This model's USB port is not located at the navigation system

# Step 7.2

## Map installation on the Navigation System

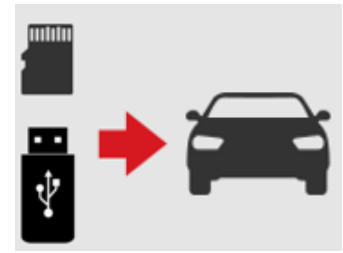

- ① Navigation system will first power off automatically
- ② Navigation system will restart to begin the installation process
- ③ Installation process on the navigation system will take up to 3 minutes
- ④ Navigation system will restart again after the installation
- ⑤ Update is complete when you see “Update successfully” message

**\* Do not power off the unit / turn off engine during the installation process**

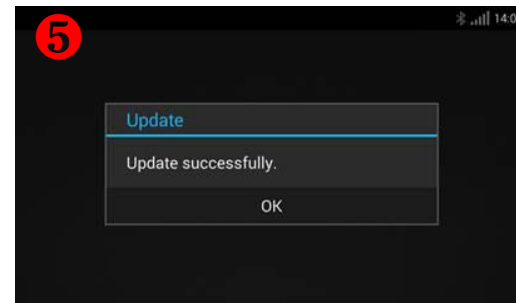
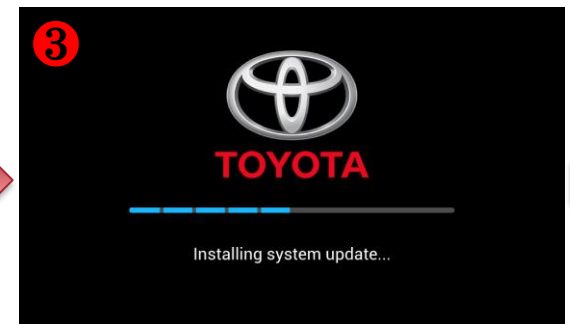
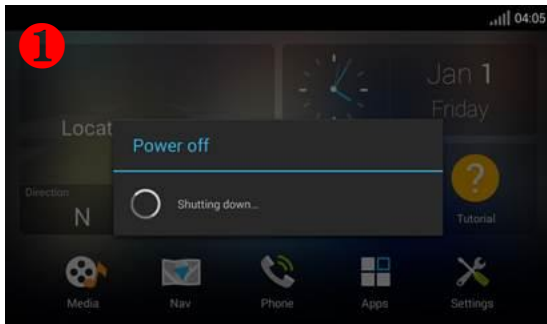

# Step 8

## Update complete

- “Update successfully” message will be shown when completed  
(Note: If you do not see the screen below, refer to [Trouble Shooting](#))
- Touch “OK” to continue

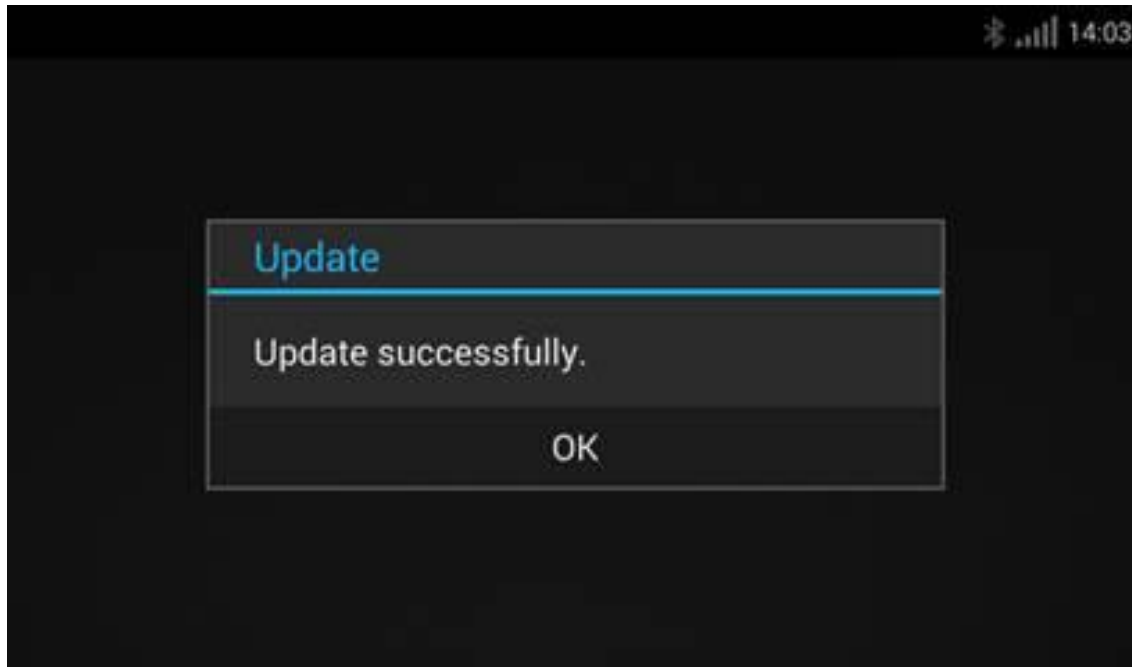
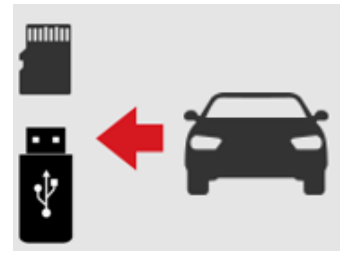

# Step 9

## Check map version on the Navigation system

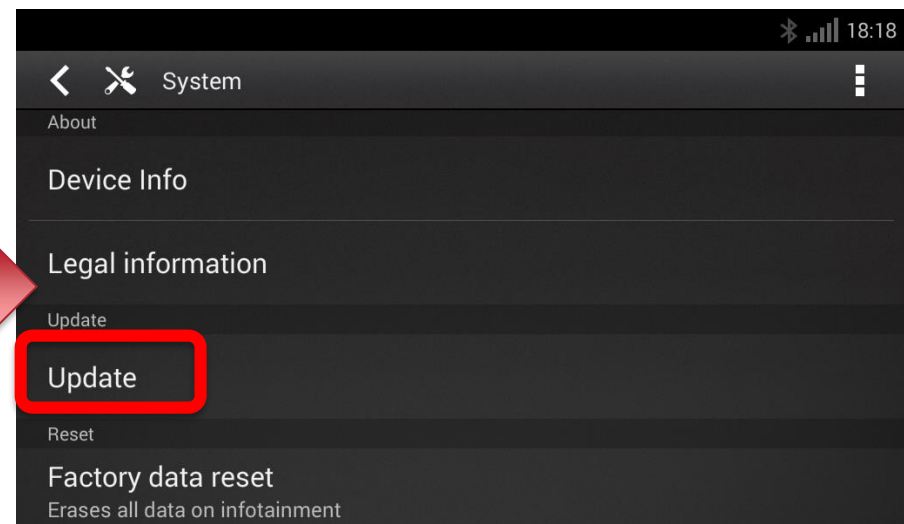
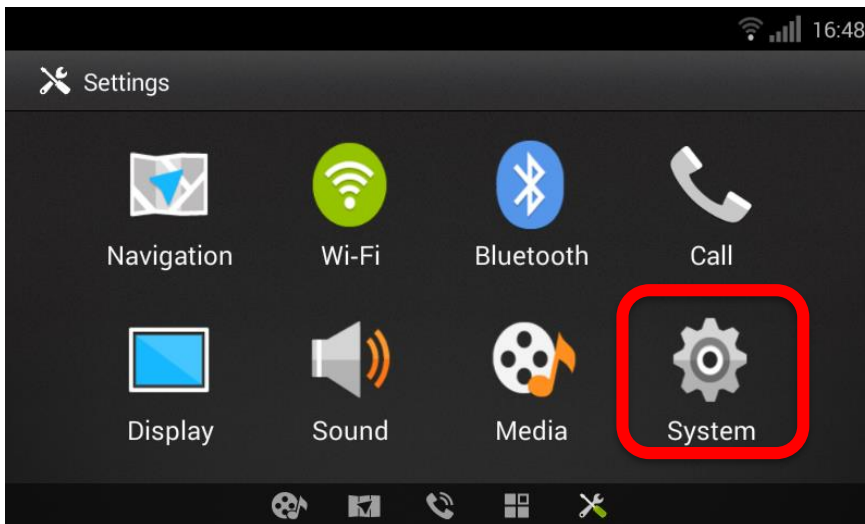
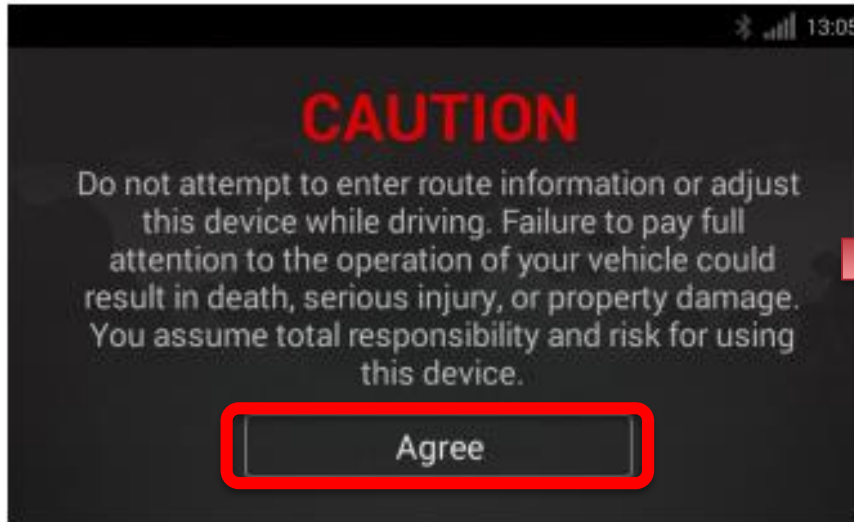

# Step 9.1



## Check map version on the Navigation system

- Check if the Map Version is the same as below

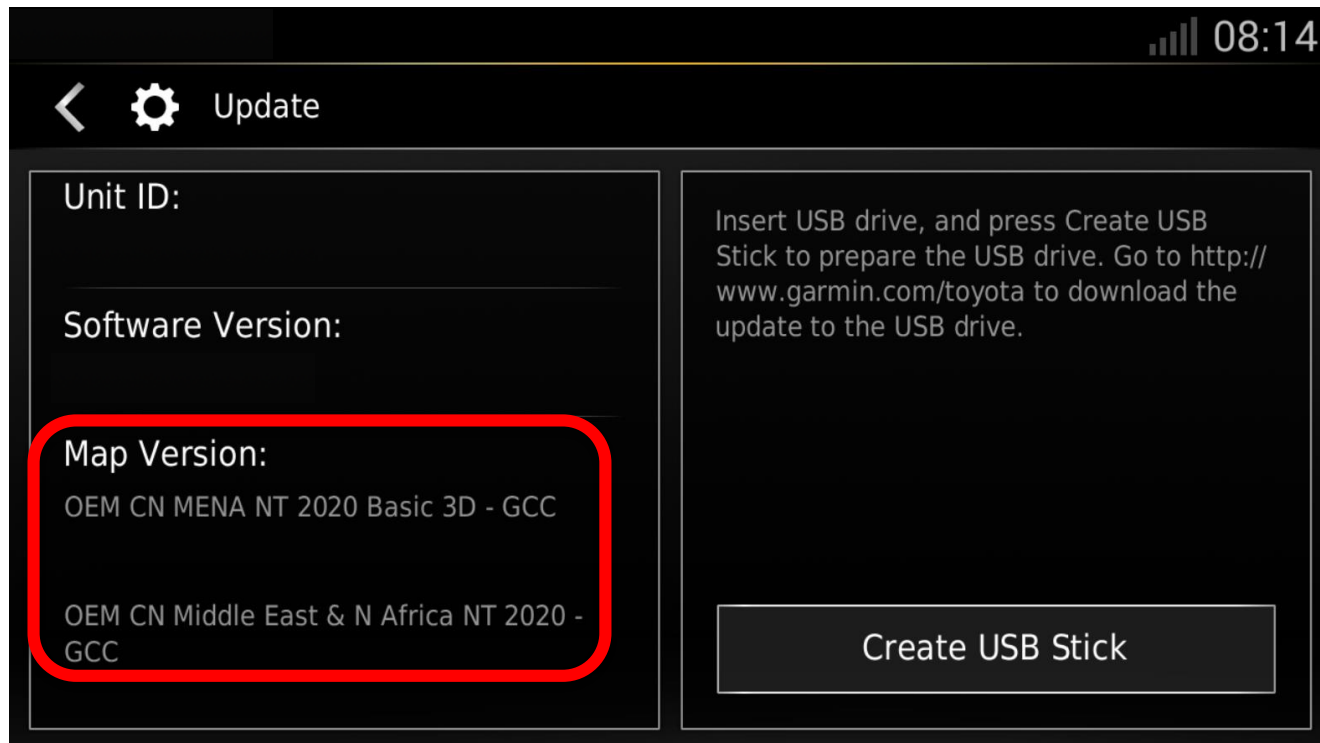

# Trouble Shooting

## Update incomplete

- If the following message appears, touch “OK” and start over from [Step 1](#)

